

**TECHNICAL MANUAL**

**GENERAL SUPPORT MAINTENANCE**

**REPAIR PARTS AND  
SPECIAL TOOLS LIST**

**INDICATOR CONTROL  
C-10027/USQ  
NSN 5865-01-071-1876**

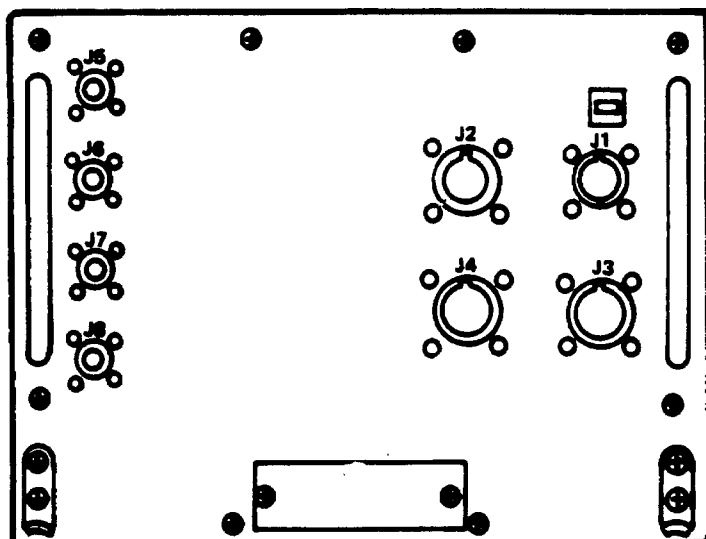

This publication is not available through AG Publication Center. Requisitions for this document must be referred to U.S. Army Communications Electronics Activity-Vint Hill, Attn: SELCE-MR-E-P, Vint Hill Farms Station, Warrenton, VA 22186-5144.

Headquarters, Department of the Army

**INTRODUCTION**

**INDICATOR CONTROL  
REPAIR PARTS LIST**

**CCA A2 AND CCA A3  
REPAIR PARTS LISTS**

**CCA A7 REPAIR PARTS  
LISTS**

**FIGURE AND ITEM  
NUMBER INDEX**

**NATIONAL STOCK  
NUMBER INDEX**

**REFERENCE  
DESIGNATOR INDEX**

**PART NUMBER INDEX**

**APRIL 1989**

**GENERAL SUPPORT MAINTENANCE  
REPAIR PARTS AND SPECIAL TOOLS LIST  
FOR  
INDICATOR CONTROL  
C-100027/USQ  
5865-01-071-1876**

Current as of April 17, 1989

**REPORTING ERRORS AND RECOMMENDING IMPROVEMENTS**

You can help improve this manual. If you find any mistakes or if you know a way to improve the procedures, please let us know. Mail your letter, DA Form 2028, Recommended Changes to Publications and Blank Forms, or DA Form 2028-2 located at the back of this manual, direct to: Commander, U.S. Army Communications Electronics Activity-Vint Hill, Attn: SELCE-MR-E-P, Vint Hill Farms Station, Warrenton, Virginia 22186-5144. A reply will be furnished to you.

**TABLE OF CONTENTS**

		<b>Title</b>	<b>Page</b>
		How To Use This Manual .....	iii
Section	I.	Introduction.....	1
Section	II.	Repair Parts List.....	9
Group	31	Indicator Control .....	9
	3126	Sweep Address CCA A2 .....	15
	3127	Timing Controller CCA A3.....	18
	3128	Memory Address CCA A4 .....	21
	3130	Memory CCA A6 .....	24
	3131	RCU Interface CCA A7.....	27
Section	III.	Special Tools List .....	31
Section	IV.	Cross Reference Indexes.....	33
		Figure and Item Number Index .....	33
		National Stock Number Index.....	38
		Reference Designator Index.....	40
		Part Number Index .....	42

**LIST OF ILLUSTRATIONS**

<b>Figure</b>	<b>Title</b>	<b>Page</b>
1-1	Indicator Control Unit C-10027/USQ.....	11
1-2	Special Purpose Cable Assembly (W20) .....	13
1-3	Sweep Address CCA A2 .....	15
1-4	Timing Controller CCA A3.....	18
1-5	Memory Address CCA A4 .....	21
1-6	Memory CCA A6 .....	24
1-7	RCU Interface CCA A7.....	27

## HOW TO USE THIS MANUAL

This manual is designed to help you order parts to maintain the equipment. The written procedures and pictures should be used together to help you do your job. Don't skip steps and don't take short cuts.

Before you begin any task, you should read through the complete procedure, make sure you know what needs to be done, then go back and follow the steps as written.

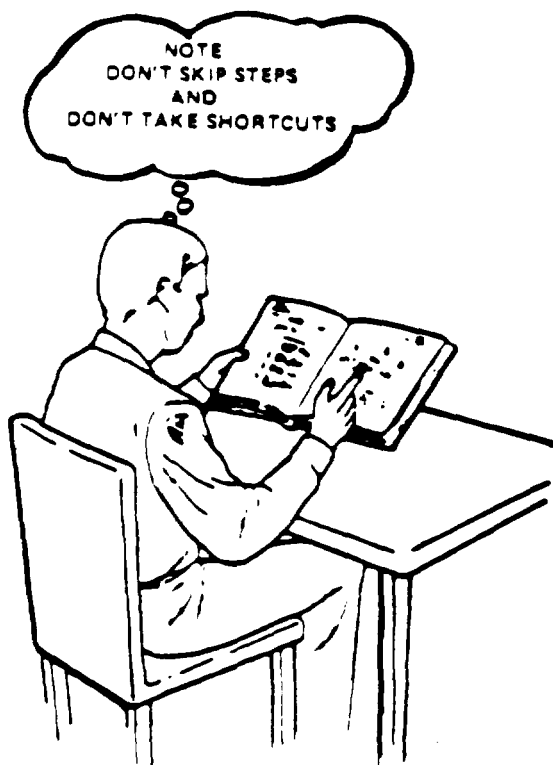

1. On the cover of this manual is an index with bars on the right-hand edge. Next to each bar is a section title.

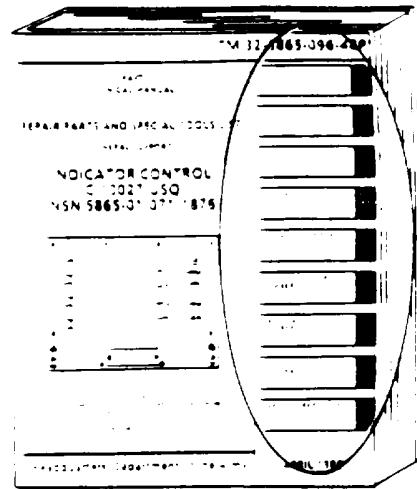

2. Bend the pages a bit and look at the edges. The black bars on the first page of each section are lined up with the bars on the cover.

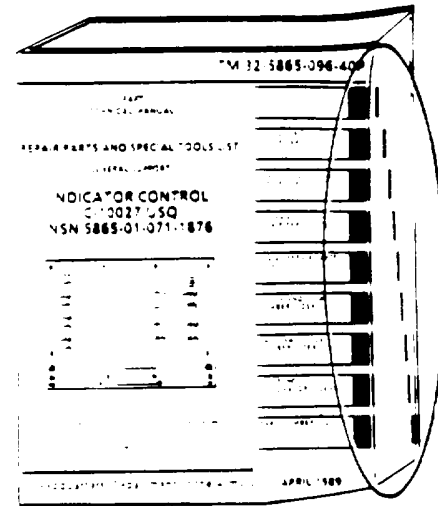

3. Flip through the pages to find the bar that matches the one on the cover for the section you want to use.

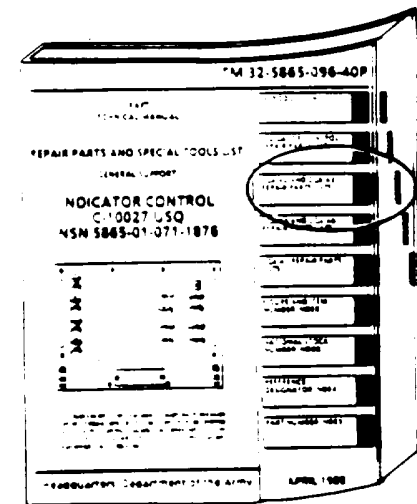

This manual is divided into four sections:

- Section I - INTRODUCTION
- Section II - REPAIR PARTS LIST
- Section III - SPECIAL TOOLS LIST (Not Applicable)
- Section IV - FIGURE AND ITEM NUMBER, NATIONAL STOCK NUMBER, REFERENCE DESIGNATOR, AND PART NUMBER INDEXES

- Section I - Contains general information about the manual and how to use the following sections.
- Section II - Contains a list of spares and repair parts authorized for use in the performance of maintenance.
- Section III - Contains a list of special tools, special Test Measurement, and Diagnostic Equipment (TMDE), and other special support equipment authorized for maintenance performance.
- Section IV - Contains a list of all National Stock Numbers (NSNs) appearing on the listings followed by a list of all part numbers appearing in the listings.

**v/(vi blank)**

## GENERAL SUPPORT MAINTENANCE REPAIR PARTS AND SPECIAL TOOLS LIST

### Section I. INTRODUCTION

1. **Scope.** This manual lists spares and repair parts; special tools; special Test, Measurement, and Diagnostic Equipment (TMOE), and other special support equipment required for performance and general support maintenance of the Indicator Control Unit C-10027/USQ, hereinafter referred to as the Indicator Control. It authorizes the requisitioning and issue of spares and repair parts as indicated by the source maintenance codes.

2. **General.**

In addition to Section I, Introduction, this Repair Parts and Special Tools List (RPSTL) is divided into the following sections:

a. **Section II Repair Parts List.** Lists spares and repair parts authorized by this RPSTL for use in the performance of maintenance. The list also includes parts which must be removed for replacement of the authorized parts. Parts lists are composed of functional groups in ascending alphanumeric sequence. Bulk materials are listed in item name sequence. Repair parts kits are listed separately in their own functional group within Section II. Repair parts for repairable special tools are also listed in this section. Items listed are shown on the associated illustration(s)/figures(s).

b. **Section III Special Tools List.** Lists special tools, special TMOE, and other special support equipment authorized by this RPSTL (as indicated by Basis of Issue (BOI) information in DESCRIPTION AND USABLE ON CODE column) for the performance of maintenance.

c. **Section IV Cross-Reference Indexes.** Lists, in National Item Identification Number (NIIN) sequence, all National stock numbered items appearing in the listing, followed by a list in alphanumeric sequence of all numbers appearing in the listings. The National Stock Numbers (NSNs) and part numbers are cross-referenced to each illustration figure and item number appearance. Figure and item number index lists figure and item numbers in alphanumeric sequence and cross-references NSN, Commercial and Government Entity (CAGE), and Part Numbers.

3. **Explanation of Columns (Sections II and III).**

a. **ITEM NUMBER Column (1).** Indicates the number used to identify items called out in the illustration.

b. **SMR CODE Column (2).** SMR code is a 5-position code containing supply/requisitioning information, maintenance category authorization criteria, and disposition instruction, as shown in the following breakout:

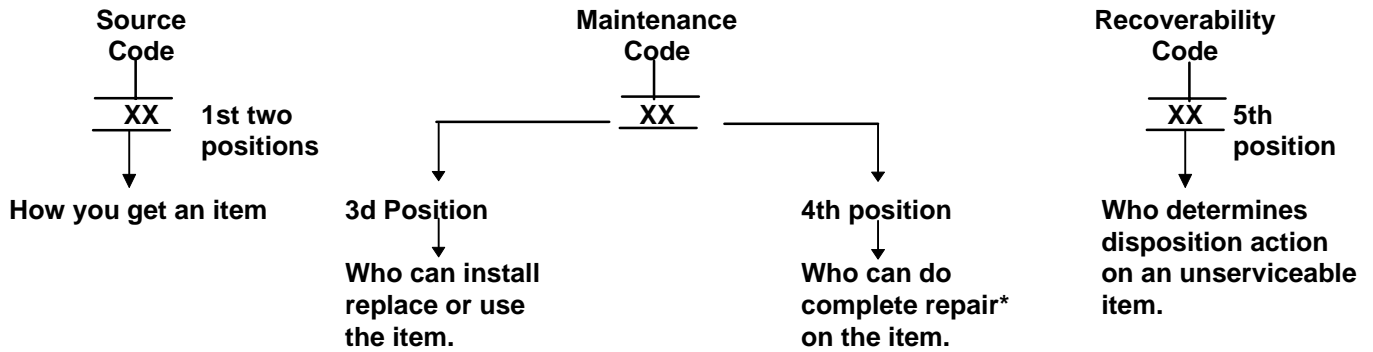

\*Complete Repair: Maintenance capacity, capability, and authority to perform all corrective maintenance tasks of the "Repair" function in a use/user environment in order to restore serviceability to a failed item.

(1) Source Code. The source code tells you how to get an item needed for maintenance, repair, or overhaul of an end item/equipment. Explanation of source codes follows:

**Code**

- PA
- PB
- PC
- PD
- PE
- PF
- PF

- KB
- KD
- KF

- MO - Made at Org/AVUM category
- MF - Made at DS/AVIM category
- MH - Made at GS category
- ML - Made at Specialized Repair Activity (SRA)
- MD - Made at Depot

**Explanation**

Stocked items: use applicable NSN to request and/or requisition items with these source codes. They are authorized to the category indication by the code entered in the third position of the SMR code.

**\*\*NOTE**

**Items coded PC are subject to deterioration.**

Items with these codes are not to be requested/requisitioned individually. They are part of a kit which is authorized to the maintenance level indicated in the 3d position of the SMR code. The complete kit must be requisitioned and applied.

Items with these codes are not to be requested/requisitioned individually. They must be made from bulk material which is identified by the part number in the DESCRIPTION AND USABLE ON CODE (UOC) column and listed in the bulk material group in the parts lists in this RPSTL. If the item is authorized to you by the 3d position code of the SMR code, but the source code indicates it is made at a higher category, order the item from the higher category of maintenance.



- |                                     |
|-------------------------------------|
| AO - Assembled by Org/AVUM Category |
| AF - Assembled by DS/AVIM category  |
| AH - Assembled by GS category       |
| AL - Assembled by SRA               |
| AD - Assembled by Depot             |

Items with these codes are not to be requested/ requisitioned individually. The parts that make up the assembled item must be requisitioned or fabricated and assembled at the level of maintenance indicated by the source code. If the 3d position code of the SMR code authorizes you to replace the item, but the source code indicates the item is assembled at a higher level, order the item from the higher level of maintenance.

- XA - Do not requisition an "XA" - coded item. Order its next higher assembly. (Also, refer to the NOTE Below.)
- XB - If an "XB" item is not available from salvage, order it using the CAGE Code and part number given.
- XC - Installation drawing, diagram, instruction sheet, field service drawing, that is identified by manufacturer's part number.
- XD - Item is not stocked. Order an "XD" - coded item through normal supply channels using the CAGE Code and part number given, if no NSN is available.

**NOTE**

**Cannibalization or controlled exchange, when authorized, may be used as a source of supply for items with the above source codes, except for those source coded "XA" or those aircraft support items restricted by requirements of AR 750-1.**

(2) Maintenance Code. Maintenance codes tell you the level(s) of maintenance authorized to USE and REPAIR support items. The maintenance codes are entered in the third and fourth positions of the SMR Code as follows:

(a) The maintenance code entered in the third position tells you the lowest maintenance level authorized to remove, replace, and use an item. The maintenance code entered in the third position will indicate authorization to one of the following levels of maintenance.

<b>Code</b>	<b>Application/Explanation</b>
C	-Crew or operator maintenance done within organizational or aviation unit maintenance.
O	-Organizational or aviation unit category can remove, replace, and use the item.
F	-Direct support or aviation intermediate level can remove, replace, and use-the item.
H	-General support level can remove, replace, and use the item.

- L -Specialized repair activity can remove, replace, and use the item.
- D -Depot level can remove, replace, and use the item.

(b) The maintenance code entered in the fourth position tells whether or not the item is to be repaired and identifies the lowest maintenance level with the capability to do complete repair (i.e., perform all authorized repair functions.) (Some limited repair may be done on the item at a lower level of maintenance, if authorized by the Maintenance Allocation Chart (MAC) and SMR codes.) This position will contain one of the following maintenance codes.

<b>Code</b>	<b>Application/Explanation</b>
O	-Organizational or (aviation unit) is the lowest level that can do complete repair of the item.
F	-Direct support or aviation intermediate is the lowest level that can do complete repair of the item.
H	-General support is the lowest level that can do complete repair of the item.
L	-Specialized repair activity (designate the specialized repair activity) is the lowest level that can do complete repair of the item.
D	-Depot is the lowest level that can do complete repair of the item.
Z	-Nonrepairable. No repair is authorized.
B	-No repair is authorized. (No parts or special tools are authorized for the maintenance of a "B" code item). However, the item may be reconditioned by adjusting, lubricating, etc., at the user level.

(3) Recoverability Code. Recoverability codes are assigned to items to indicate the disposition action on unserviceable items. The recoverability code is entered in the fifth position of the SMR Code as follows:

<b>Recoverability Codes</b>	<b>Application/Explanation</b>
Z	-Nonrepairable item. When unserviceable, condemn and dispose of the item at the level of maintenance shown in 3d position of SMR Code.
O	-Repairable item. When uneconomically repairable, condemn and dispose of the item at organizational or aviation unit level.

- F -Repairable item. When uneconomically repairable, condemn and dispose of the item at the direct support or aviation intermediate level.
- H -Repairable item. When uneconomically repairable, condemn and dispose of the item at general support level.
- D -Repairable item. When beyond lower level repair capability, return to depot. Condemnation and disposal of item not authorized below depot level.
- L -Repairable item. Condemnation and disposal not authorized below specialized repair activity (SRA).
- A -Item requires special handling or condemnation procedures because of specific reasons (e.g., precious metal content, high dollar value, critical material, or hazardous material). Refer to appropriate manuals/directives for specific instructions.

c. CAGE Column (3). The CAGE Code is a 5-digit numeric code which is used to identify the manufacturer, distributor, or Government agency, etc., that supplies the item. Refer to AR 708-1.

d. PART NUMBER Column (4). Indicates the primary number used by the manufacturer (individual, company, firm, corporation, or Government activity), which controls the design and characteristics of the item by means of its engineering drawings, specifications standards, and inspection requirements to identify an item or range of items.

**NOTE**

**When you use a NSN to requisition an item, the item you receive may have a different part number from the part ordered.**

e. DESCRIPTION AND USABLE ON CODE (UOC) Column (5). This column includes the following information:

(1) The Federal item name and, when required, a minimum description to identify the item.

(2) The physical security classification of the item is indicated by the parenthetical entry (insert applicable physical security classification abbreviation), e.g., Phy Sec C1 (C) -Confidential, Phy Sec C1 (S) -Secret, Phy Sec C1 (T) Top Secret).

(3) Items that are included in kits and sets are listed below the name of the kit or set.

(4) Spare/repair parts that make up an assembled item are listed immediately following the assembled item line entry.

(5) Part numbers for bulk materials are referenced in this column in the line item entry for the item to be manufactured/fabricated.

(6) When the item is not used with all serial numbers of the same model, the effective serial numbers are shown on the last line(s) of the description (before UOC).

(7) The usable on code, when applicable (see paragraph 5, Special information.

(8) In the Special Tools List section, the Basis Of Issue (BOI) appears as the last line(s) in the entry for each special tool, special TMDE, and other special support equipment. When density of equipments supported exceeds density spread indicated in the basis of issue, the total authorization is increased proportionately.

(9) The statement "End of Figure" appears just below the last item description in Column 5 for a given figure in both Section II and Section III.

f. QUANTITY Column (6). The Quantity (QTY) per figure column indicates the quantity of the item used in the breakout shown on the illustration figure, which is prepared for a functional group, subfunctional group, or an assembly. A "V" appearing in this column in lieu of a quantity indicates that the quantity is variable and the quantity may vary from application to application.

**4. Explanation of Columns (Section IV).**

a. NSN INDEX.

(1) STOCK NUMBER Column. This column lists the NSN by National Item Identification Number (NIIN) sequence. The NIIN consists of the last nine  

$$\frac{\text{NSN}}{\text{NIIN}}$$
 digits of the NSN (i.e., 5305-01-674-1467). When using this column to locate an item, ignore the first 4 digits of the NSN. However, the complete NSN should be used when ordering items by stock number.

(2) FIGURE Column. This column lists the number of the figure where the item is identified/located. The figures are in numerical order in Section II and Section III.

(3) ITEM Column. The item number identifies the item associated with the figure listed in the adjacent FIG. column. This item is also identified by the NSN listed on the same line.

b. PART NUMBER INDEX. Part numbers in this index are listed by part number in ascending alphanumeric sequence (i.e., vertical arrangement of letter and number combination which places the first letter or digit of each group in order A through Z, followed by the numbers 0 through 9 and each following letter or digit in like order).

(1) CAGE Column. The CAGE is a 5-digit numeric code used to identify the manufacturer, distributor, or Government agency, etc., that supplies the item.

(2) PART NUMBER Column. Indicates the primary number used by the manufacturer (individual, firm, corporation, or Government activity), which controls the design and characteristics of the item by means of its engineering drawings, specifications, standards, and inspection requirements to identify an item or range of items.

(3) STOCK NUMBER Column. This column lists the NSN for the associated part number and manufacturer identified in the Part Number and CAGE columns to the left.

(4) FIGURE Column. This column lists the number of the figure where the item is identified/located in sections II and III.

(5) ITEM Column. The item number is that number assigned to the item as it appears in the figure referenced in the adjacent figure number column.

c. FIGURE AND ITEM NUMBER INDEX.

(1) FIGURE Column. This column lists a number of the figure where the item is identified/located in sections II and III.

(2) ITEM Column. The item number is that number assigned to the item as it appears in the figure referenced in the adjacent figure number column.

(3) STOCK NUMBER Column. This column lists the NSN for the item.

(4) CAGE Column. The CAGE is a five-digit numeric code used to identify the manufacturer, distributor, or Government agency, etc., that supplies the item.

(5) PART NUMBER Column. It indicates the primary number used by the manufacturer (individual, firm, corporation, or Government activity), which controls the design and characteristics of the item by means of its engineering drawings, specifications, standards, and inspection requirements to identify an item or range of items.

5. Special Information. Use the following subparagraphs as applicable:

a. KITS. Line item entries for repair parts kits appear in a group in section II (see table of contents).

b. INDEX NUMBERS. Items which have the word BULK in the figure column will have an index number shown in the item number column. This index number is a cross-reference between the National Stock Number/Part Number Index and the bulk material list in section II.

c. MISSING NSNs. NSNs which are missing from D source coded items have been applied for and will be added to this Technical Manual (TM) by future change or revision when they are entered in the Army Master Data File (AMDF). Until the NSNs are established and published, submit an exception requisition to Commander, Communications Electronics Activity-Vint Hill, Attn: SELCE-MR-E-P, Vint Hill Farms Station, Warrenton, Virginia 22186-5144.

6. How to Locate Repair Parts.

a. When NSN or Part Number is Not Known.

(1) First. Using the table of contents, determine the assembly group or subassembly group to which the item belongs. This is necessary since figures are prepared for assembly groups and subassembly groups, and listings are divided into the same groups.

(2) Second. Find the figure covering the assembly group or subassembly group to which the item belongs.

(3) Third. Identify the item on the figure and note the item number.

b. When NSN or Part Number is known.

(1) First. Using the Index of NSNs and Part Numbers, find the pertinent NSN or Part Number. The NSN index is in NIIN sequence (see 4.1(1)). The part numbers in the Part Number Index are listed in ascending alphanumeric sequence (see 4.b). Both indexes cross-reference you to the illustration figure and item number of the item you are looking for.

(2) Second. Turn to the figure and item number, verify that the item is the one you're looking for, then locate the item number in the repair parts list for the figure.

Section II. REPAIR PARTS LIST

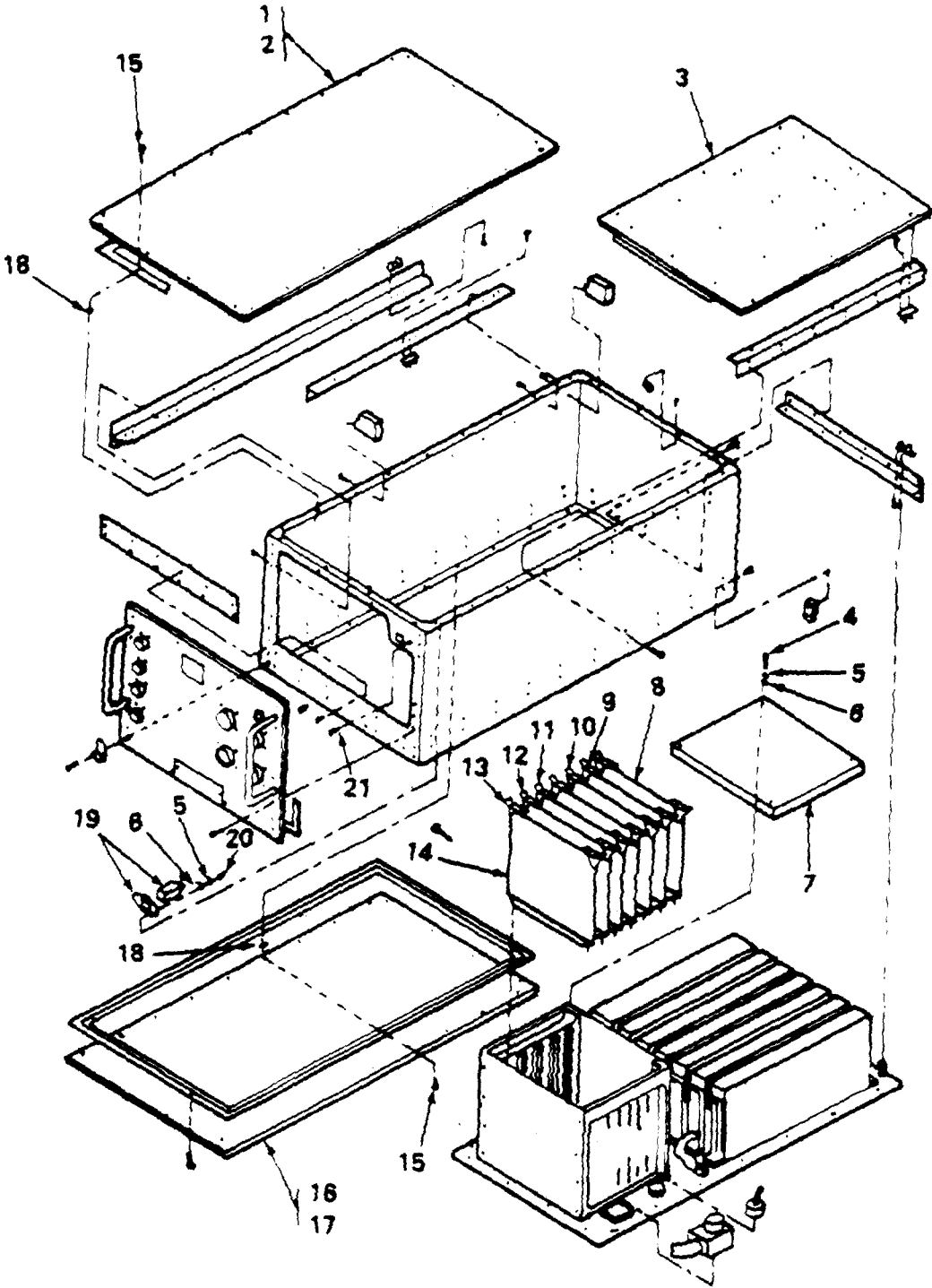

FIGURE 1-1. Indicator Control C-1007/USQ. (Sheet 1 of 3).

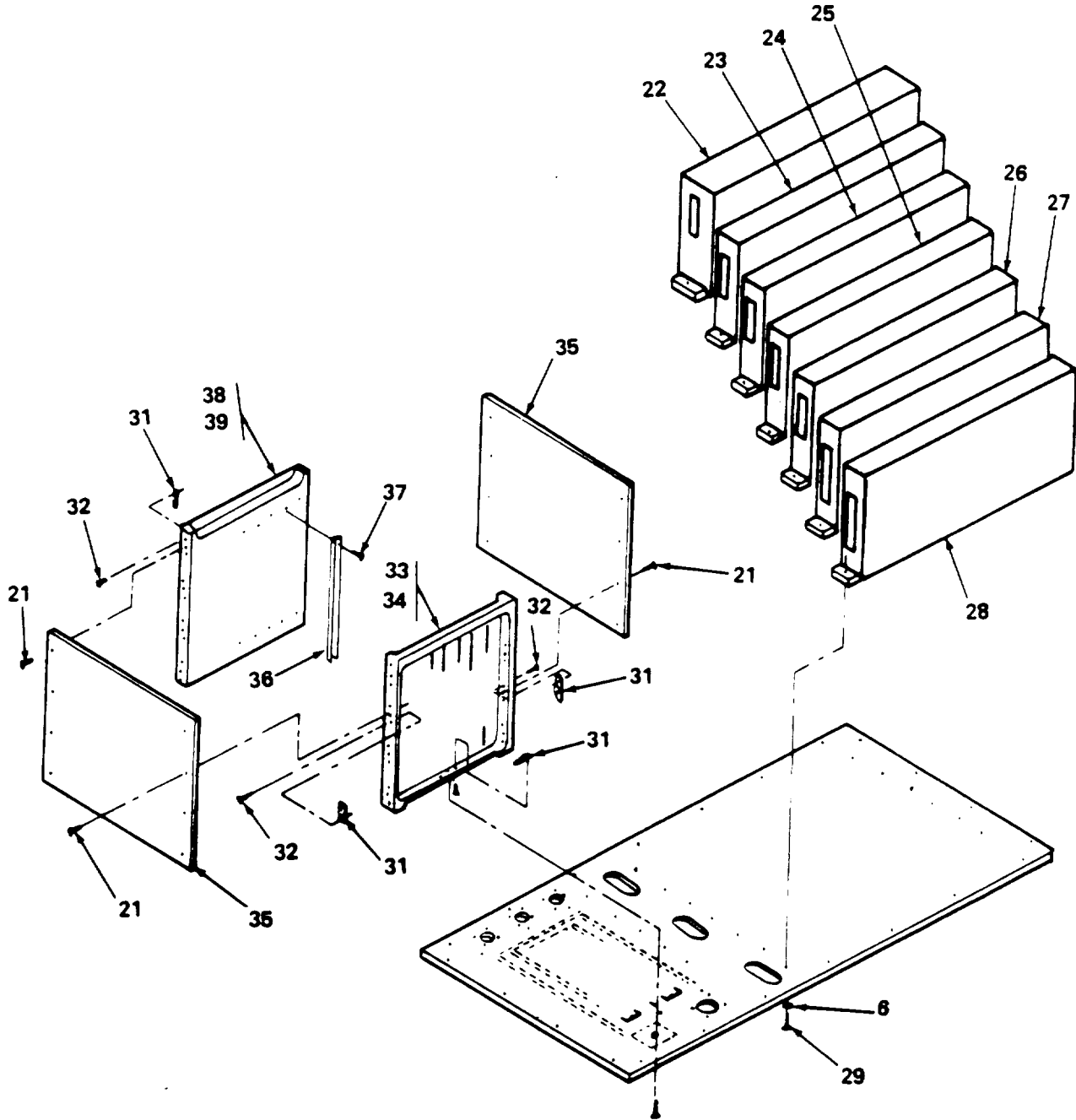

FIGURE 1-1. *Indicator Control C10027/USQ. (Sheet 2 of 3)*



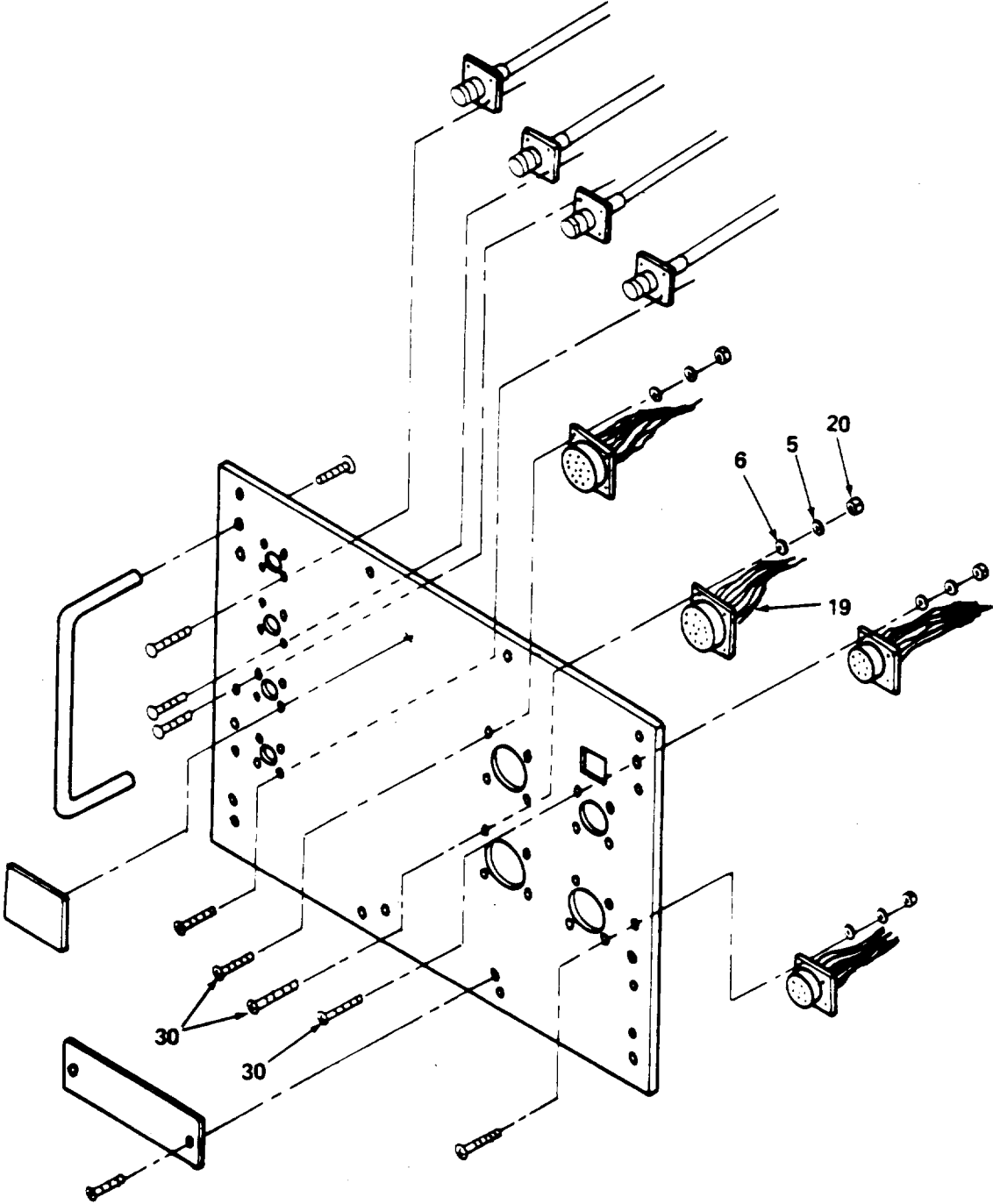

FIGURE 1-1. *Indicator Control C1007/USQ. (Sheet 3 of 3)*

FIGURE: 1-1

ITEM	SMR	CAGE	PART NUMBER	DESCRIPTION	QTY
1	XDHHH	15942	1951-1-5023-2	COVER, ACCESS	1
2	XA	15942	1951-1-5023-501	COVER, ACCESS	1
3	PAHDD	15942	1951-1-4204-1	ECA, FRONT END	1
4	XDDZZ	96906	MS51957-14	SCREW, MACHINE	10
5	XDHZZ	96906	MS35338-135	WASHER, LOCK	10
6	XDHZZ	96906	MS15795-803	WASHER, FLAT	30
7	XDDZZ	15942	1951-1-4264-1	COVER, CARD CAGE	1
8	PAHDD	28815	10-123614-1	CCA, RCU INTERFACE	1
9	PAHDD	57958	C5135457-1	CCA, MEMORY	1
10	PAHDD	28815	10-123594-1	CCA, MEMORY I/O BUFFER	1
11	PAHDD	28815	10-123624-2	CCA, MEMORY ADDRESS	1
12	PAHDD	15942	1951-1-4137-1	CCA, TIME CONTROL	1
13	PAHDD	28815	10-123584-1	CCA, SWEEP. ADDRESS	1
14	PAHDD	15942	1951-1-4873-2	CCA, CIRCUIT CLOCK	1
15	XDHZZ	30885	D-791806	SCREW, ERB	52
16	XDHHH	15942	1951-1-4021-1	COVER, ACCESS BOTTOM	1
17	XA	15942	1951-1-4021-501	COVER, ACCESS BOTTOM	1
18	XDHZZ	96906	MS15795-802	WASHER, FLAT	52
19	XDHHH	15942	1951-1-3297-1	CABLE ASSY, SP (W20)	1
20	XDHZZ	80205	NAS671C4L	NUT, PLAIN, HEXAGON	6
21	XDHZZ	96906	MS24693-C3	SCREW, MACHINE	28
22	PAHDD	15942	1951-1-4133-1	ECA, IF AMPLIFIER	1
23	PAHDD	28815	10-123525-1	ECA, LOG AMPLIFIER	1
24	PAHDD	28815	10-123495-1	RF TEST GEN	1
25	PAHDD	15942	1951-1-4128-1	ECA, RF OSCILLATOR	1
26	PAHDD	28815	10-123505-1	ECA, FREQUENCY CONVERTER	1
27	PAHDD	28815	10-123545-1	ECA, FREQUENCY DISCRIM	1
28	PAHDD	28815	10-123555-1	ECA, RECEIVER SWEEP	1
29	XDDZZ	96906	MS51957-16	SCREW, MACHINE	14
30	XDHZZ	96906	MS24693C4	SCREW, MACHINE	4
31	XDDZZ	15653	MK1301-04	NUT, SEK-LOCKING, PL	74
32	XDDZZ	96906	MS20426AD2-3	RIVET, SOLID	58
33	XDDDD	15942	1951-1-4083-1	PLATE, SIDE, CARD CAGE	1
34	XA	15942	1951-1-4083-501	PLATE, SIDE	1
35	XDDZZ	15942	1951-1-3040-1	PLATE, END, CARD CAGE	2
36	XDDZZ	18915	35-7B2-10-3	HOLDER, ELECTRIC CARD	14
37	XDDZZ	96906	MS20470AD2-2	RIVET, SOLID	28
38	XDDDDZ	15942	1951-1-4083-2	PLATE, SIDE, CARD CAGE	1
39	XA	15942	1951-1-4083-502	PLATE, SIDE	1
40	XDHZZ	46384	FE-832	NUT, SLF-LKG, CLINCH	4
41	XDHZZ	96906	MS51957-44	SCREW	4
42	XDHZZ	94867	HDH-4	HOOK, HOLDDOWN	2
43	XDHZZ	15942	1951-1-4195-1	FRONT PANEL	1

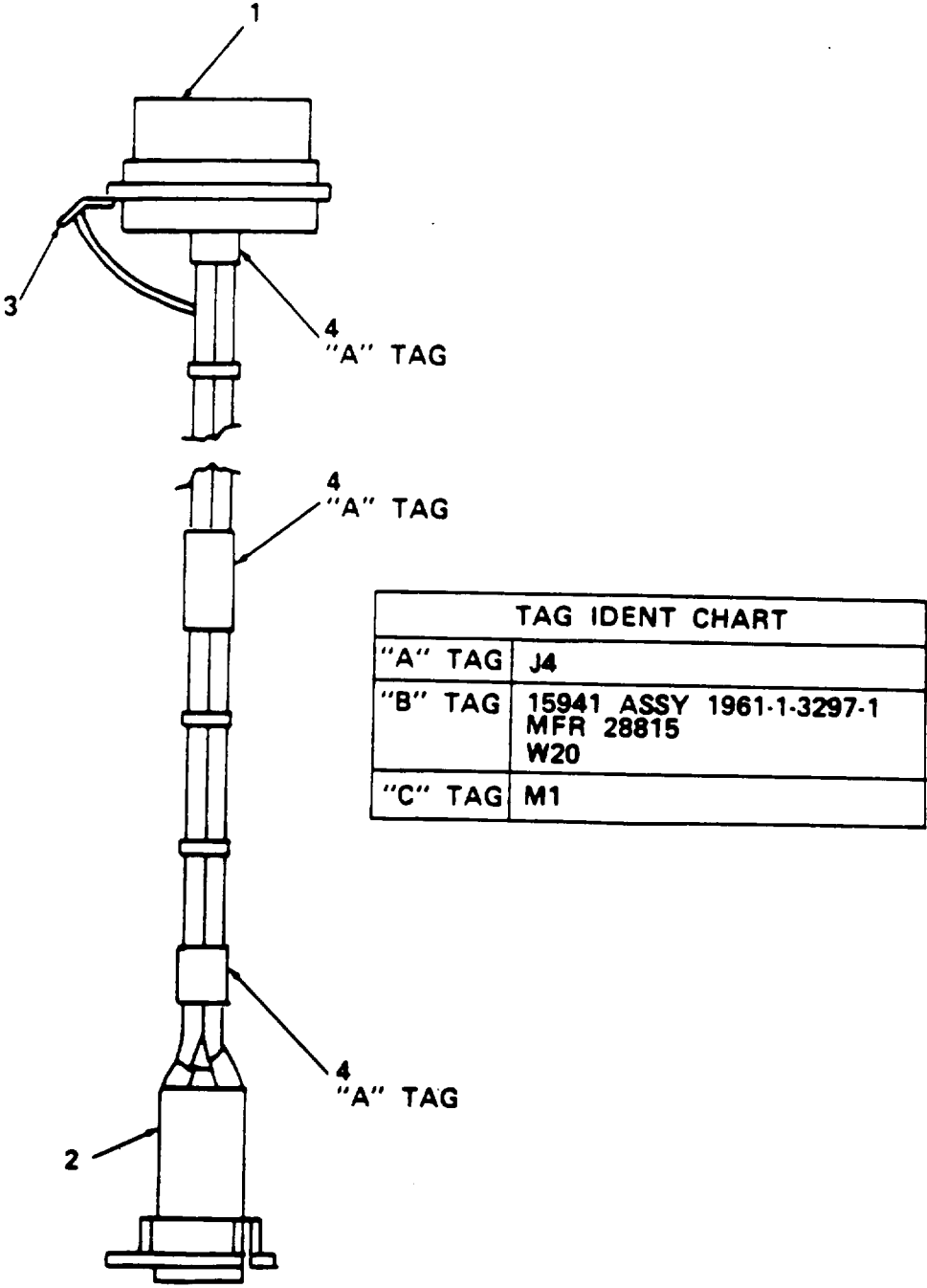

Figure 1-2. Special Purpose Cable Assembly (W20).

FIGURE: 1- 2

ITEM	SMR	CAGE	PART NUMBER	DESCRIPTION	QTY
1	PAHZZ	96906	MS27508E16F8P	CONN, RCPT	1
2	PAHZZ	12436	A24514-001	METER, TIME TOTALIZER	1
3	XDHZZ	96906	MS77068-1	TERMINAL, LUG	1
4	XDHZZ	06090	TMS1/4-9	BAND, MARKER	3

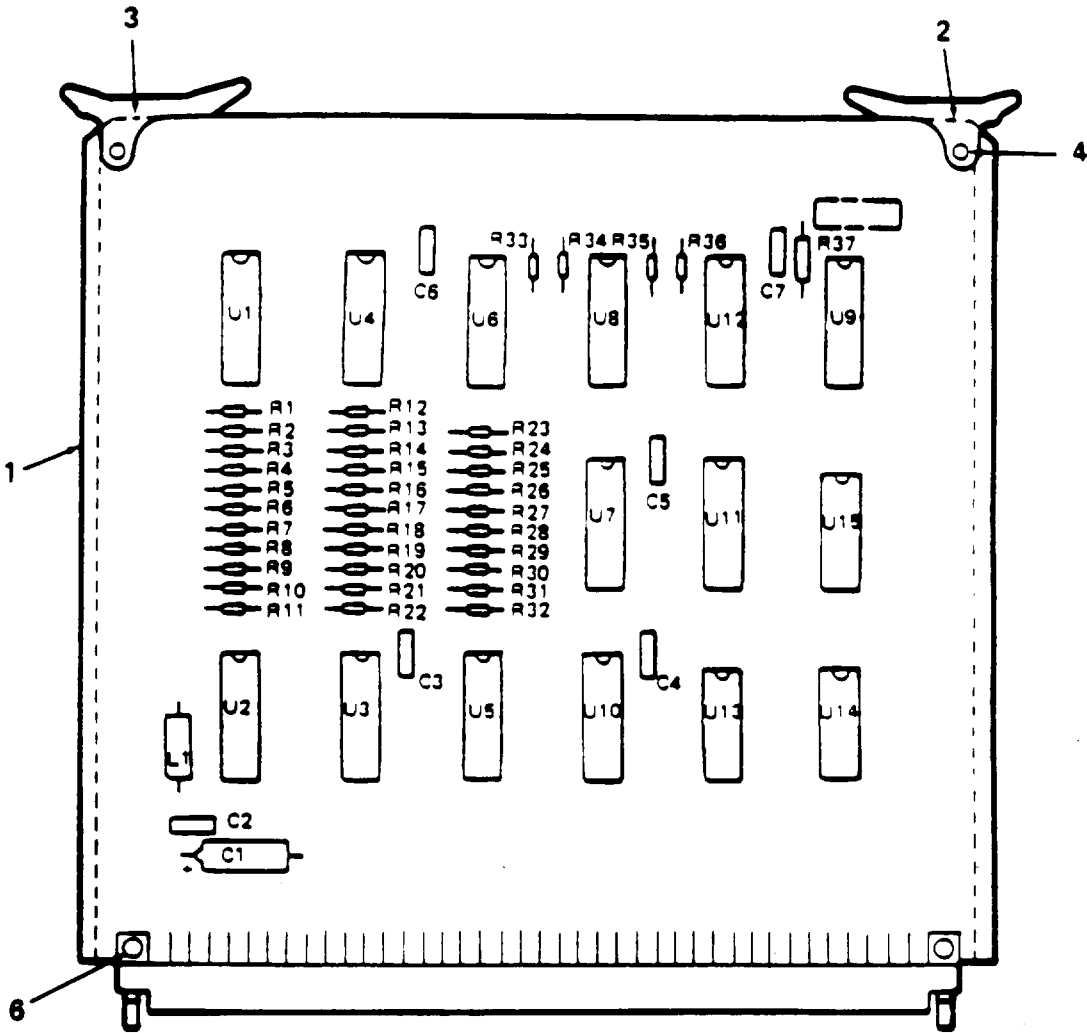

FIGURE 1-3. Sweep Address CCA A2 (Sheet 1 of 2)

LEGEND

REF DES	ITEM NO	REF DES	ITEM NO	REF DES	ITEM NO	REF DES	ITEM NO	REF DES	ITEM NO	REF DES	ITEM NO
C1	7	R37	11								
C2	8	U1	12								
C3	8	U2	12								
C4	8	U3	12								
C5	8	U4	12								
C6	8	U5	12								
C7	8	U6	12								
L1	9	U7	12								
R1	10	U8	12								
R2	10	U9	13								
R3	10	U10	13								
R4	10	U11	13								
R5	10	U12	13								
R6	10	U13	14								
R7	10	U14	14								
R8	10	U15	15								
R9	10										
R10	10										
R11	10										
R12	10										
R13	10										
R14	10										
R15	10										
R16	10										
R17	10										
R18	10										
R19	10										
R20	10										
R21	10										
R22	10										
R23	10										
R24	10										
R25	10										
R26	10										
R27	10										
R28	10										
R29	10										
R30	10										
R31	10										
R32'	10										
R33	10										
R34	10										
R35	10										
R36	10										

Figure 1-3. Sweep Address CCA A2 (Sheet 2 of 2).

FIGURE: 1- 3

ITEM NUMBER	SMR CODE	CAGE	PART NUMBER	DESCRIPTION	QTY
1	XA	28815	12-123583-1	PRINTED WRG BD	1
2	XDHZZ	91506	14009-1P12	RTNR-EJCTR,CARD (WHITE)	1
3	XDHZZ	91506	14009-1P14	RTNR-EJCTR, CARD (RED)	1
4	XDHZZ	91506	14007-1P4	PIN, SPRING	2
5	XDHZZ	31413	M1001-00844-BA	CONN, RCPT	1
6	XDHZZ	96906	MS20470AD2-5	RIVET, SOLID	2
7	PAHZZ	81349	M39003/01-2526	CAP, FXD, ELECTLT	1
8	PAHZZ	81349	M39014-02-1270	CAP, FXD, CER	6
9	PAHZZ	81349	M39010/02-AIR0KP	COIL, RADIO FREQUENCY	1
10	PAHZZ	81349	RCR0SG472JP	RES, FXD, CMPSN	36
11	PAHZZ	81349	RCR07G471JP	RES, FXD, CMPSN	1
12	PAHZZ	01295	SNC54184J	MICROCKT, DGTL	8
13	PAHZZ	01295	SNJ54L193J	MICROCKT, DGTL	4
14	PAHZZ	81349	M38510/02001BCB	MICROCKT, DGTL	2
15	PAHZZ	81349	M38510/02005BCB	MICROCKT, DGTL	1

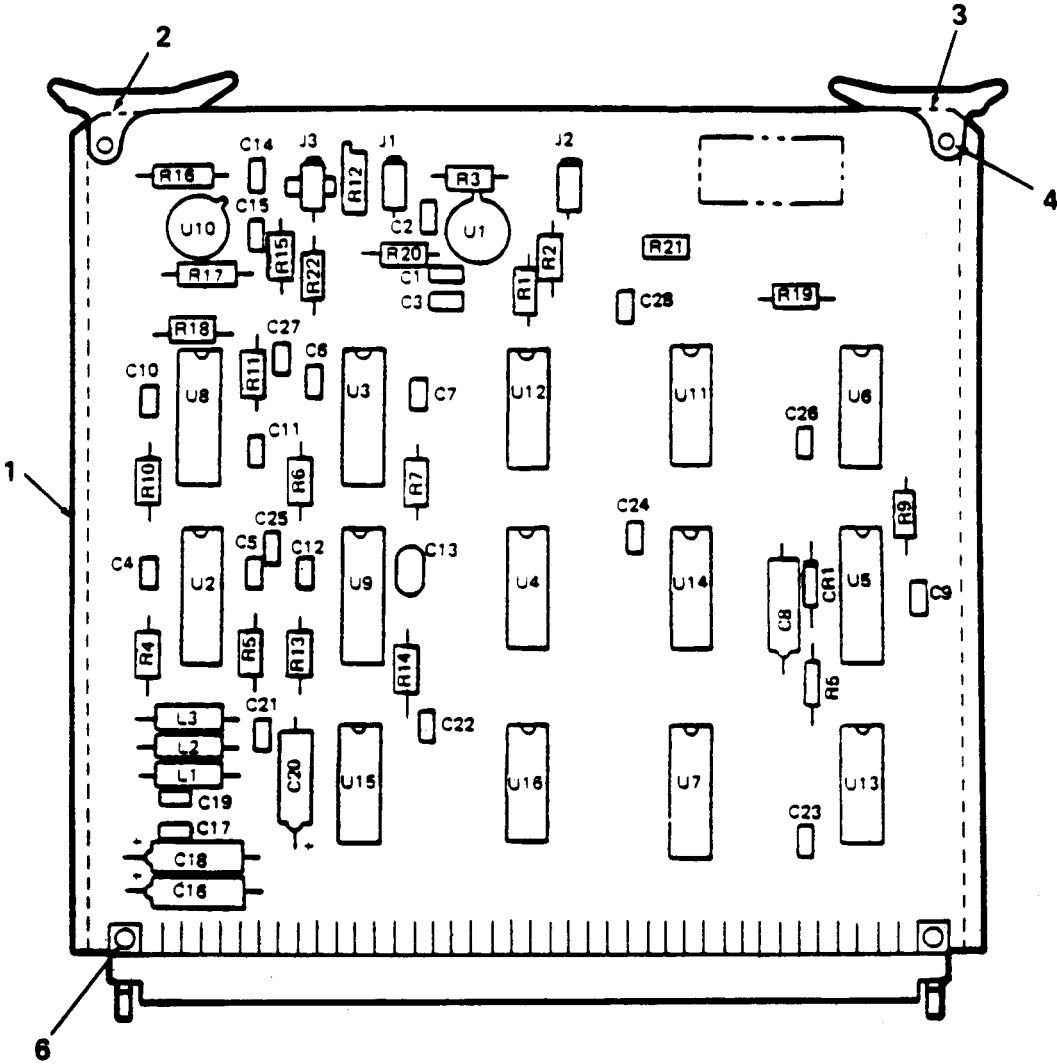

FIGURE 1-4. *Timing Controller CCA A3 (Sheet 1 of 2)*



LEGEND

REF DES	ITEM NO	REF DES	ITEM NO	REF DES	ITEM NO	REF DES	ITEM NO	REF DES	ITEM NO	REF DES	ITEM NO
CR1	17	R10	35								
C1	12	R11	30								
C2	13	R12	40								
C3	8	R13	36								
C4	14	R14	35								
C5	14	R15	37								
C6	14	R16	39								
C7	14	R17	39								
C8	11	R18	38								
C9	16	R19	38								
C10	14	R20	38								
C11	13	R21	38								
C12	14	R22	38								
C13	15	U1	19								
C14	12	U2	20								
C15	12	U3	20								
C16	9	U4	21								
C17	12	U5	20								
C18	10	U6	21								
C19	12	U7	27								
C20	10	U8	20								
C21	12	U9	20								
C22	12	U10	26								
C23	12	U11	22								
C24	12	U12	23								
C25	12	U13	23								
C26	12	U14	25								
C27	12	U15	22								
C28	12	U16	24								
J1	7										
J2	7										
J3	7										
L1	18										
L2	18										
L3	18										
R1	28										
R2	29										
R3	30										
R4	31										
R5	31										
R6	32										
R7	32										
R8	33										
R9	34										

FIGURE 1-3. *Timing Controller CCA A3 (Sheet 2 of 2)*

FIGURE: 1- 4

ITEM	SMR	CAGE	PART NUMBER	DESCRIPTION	QTY
1	XA	28815	1951-1-4136-1	PRINTED WRG BD	1
2	XDHZZ	91506	14009-1P14	RETAINER-EJECTOR, ELECTRICAL C	1
3	XDHZZ	91506	14009-1P12	EXTRACTOR, ELECTRICAL	1
4	XDHZZ	91506	14007-1P4	RETAINER-EJECTOR, ELECTRICAL	2
5	XDHZZ	31413	M1001-00844-CA	CONN, RCPT	1
6	XDHZZ	96906	MS20470AD2-5	RIVET, SOLID	72
7	XDHZZ	71279	450-3422-01-03	JACK, TIP	3
8	PAHZZ	81349	M39014/01-1495	CAP, SPEC	1
9	PAHZZ	81349	M39003/01-2526	CAP, FXD, ELECTLT	1
10	PAHZZ	81349	M39003-01-2608	CAP, FXD, ELECTLT	2
11	PAHZZ	81349	M39003/01-2523	CAP, FXD, ELECTLT	1
12	PAHZZ	81349	M39014/02-1270	CAP, FXD, CER	13
13	PAHZZ	81349	M39014/01-1483	CAP, FXD, CER	2
14	PAHZZ	81349	CMR03F101JOYP	CAP, FXD, MIC	6
15	PAHZZ	81349	CMR03F271JOYP	CAP, FXD, MIC	1
16	PAHZZ	81349	M39014-02-1411	CAP, FXD, CER	1
17	PAHZZ	81349	JANTX1N4148	SEMICONDUCTOR DEVICE, DIODE	1
18	PAHZZ	81349	M39010/0281R0KR	COIL, RADIO FREQUENCY	3
19	PAHZZ	81349	M38510/10901BGX	MICROCKT, LIN	1
20	PAHZZ	07263	96L02DMQB	MICROCKT, DGTL	5
21	PAHZZ	81349	M38510-02105BCB	MICROCKT, DGTL	2
22	PAHZZ	81349	M38510-02701BCB	MICROCKT, DGTL	2
23	PAHZZ	81349	M38510-02004BCB	MICROCKT, DGTL	2
24	PAHZZ	81349	M38510/02005BCB	MICROCKT, DGTL	1
25	PAHZZ	81349	M38510/30302BCX	MICROCKT, DGTL	1
26	PAHZZ	27014	LH0002H/883B	MICROCKT, LIN	1
27	PAHZZ	34371	HM1-7611-8	MICROCKT, DGTL	1
28	PAHZZ	81349	RCR07G100JP	RES, FXD, CMPSN	1
29	PAHZZ	81349	RCR07G471JP	RES, FXD, CMPSN	1
30	PAHZZ	81349	RCR07G682JP	RES, FXD, CMPSN	2
31	PAHZZ	81349	RCR07G823JP	RES, FXD, CMPSN	2
32	PAHZZ	81349	RCR07G223JP	RES, FXD, CMPSN	2
33	PAHZZ	81349	RCR07G124JP	RES, FXD, CMPSN	1
34	PAHZZ	81349	RCR07G473JP	RES, FXD, CMPSN	1
35	PAHZZ	81349	RCR07G104JP	RES, FXD, CMPSN	2
36	PAHZZ	81349	RCR07G154JP	RES, FXD, CMPSN	1
37	PAHZZ	81349	RCR07G472JP	RES, FXD, CMPSN	1
38	PAHZZ	81349	RCR07G102JP	RES, FXD, CMPSN	5
39	PAHZZ	81349	RCR20G101JP	RES, FXD, CMPSN	2
40	PAHZZ	81349	M39015/3-010XP	RES, VARIABLE, W	1
41	PAHZZ	81349	M38510/30102BCX	MICROCKT, DGTL	1

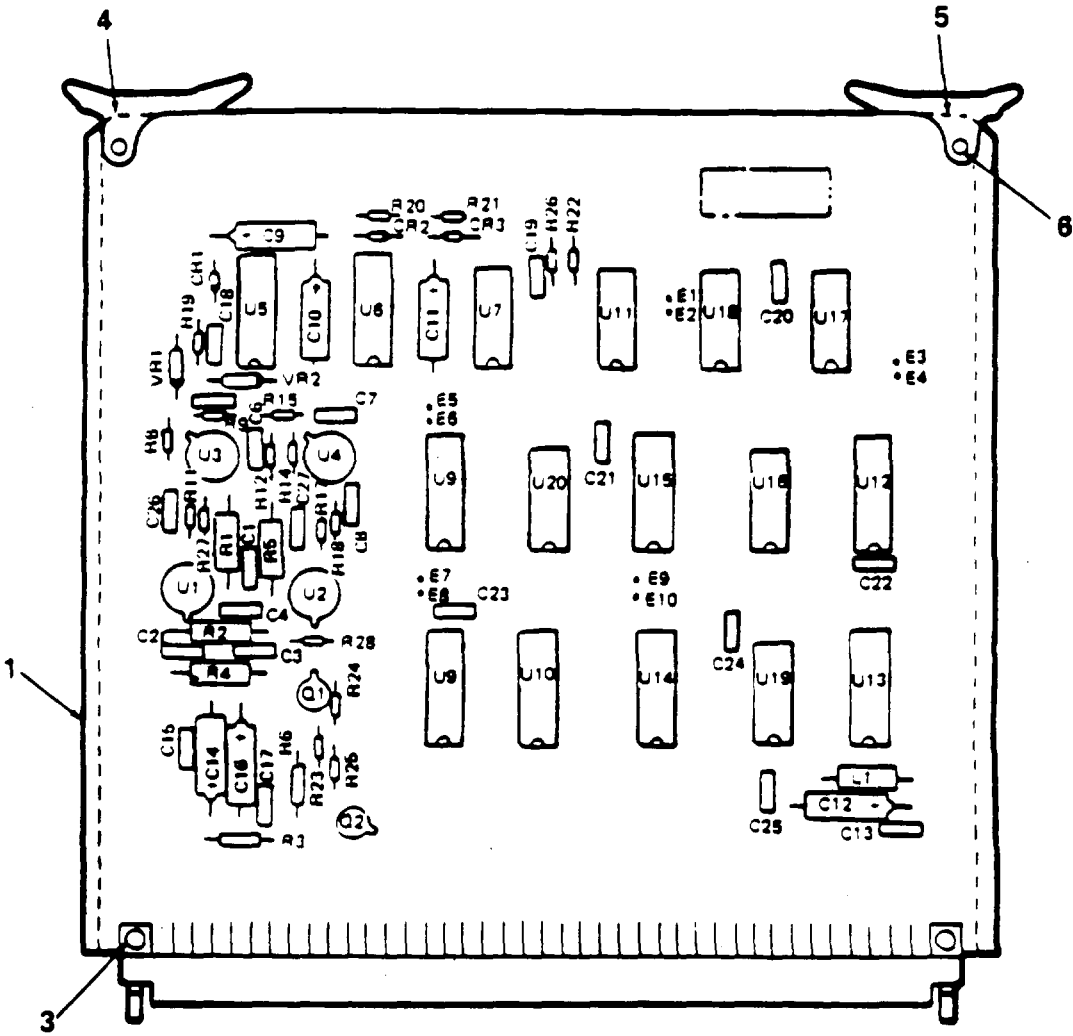

FIGURE 1-5. Memory Address CCA A4 (Sheet 1 of 2)

LEGEND

REF	ITEM	REF	ITEM	REF	ITEM	REF	ITEM	REF	ITEM	REF	ITEM
CR1	13	R15	26								
CR2	13	R17	32								
CR3	13	R18	26								
C1	9	R19	28								
C2	9	R20	28								
C3	9	R21	28								
C4	9	R22	29								
C5	9	R23	30								
C6	9	R24	29								
C7	9	R25	29								
C8	9	R26	29								
C9	7	R27	24								
C10	7	R28	24								
C11	7	U1	14								
C12	8	U2	14								
C13	9	U3	15								
C14	7	U4	15								
C15	9	U5	16								
C16	7	U6	16								
C17	9	U7	17								
C18	9	U8	18								
C19	9	U9	18								
C20	9	U10	18								
C21	9	U11	17								
C22	9	U12	18								
C23	9	U13	18								
C24	9	U14	18								
C25	9	U15	18								
C26	9	U16	17								
C27	10	U18	20								
L1	11	U19	21								
Q1	33	U20	21								
Q2	33	VR1	12								
R1	22	VR2	12								
R2	22										
R3	23										
R4	22										
R5	22										
R6	23										
R8	25										
R9	26										
R11	31										
R12	26										
R14	27										

FIGURE 1-5. Memory Address CCA A4 (Sheet 2 of 2)

FIGURE: 1-5

ITEM	SMR	CAGE	PART NUMBER	DESCRIPTION	QTY
1	XA	28815	12-123623-1	PRINTED WRG BD -	1
2	XDHZZ	28815	M1001-00844-DA	CONN	1
3	XDHZZ	96906	MS20470AD2-5	RIVET, SOLID	2
4	XDHZZ	91506	14009-1P14	RTNR-EJCTR, CARD (RED)	1
5	XDHZZ	91506	14009-1P12	RTNR-EJCTR, CARD (WHITE)	1
6	XDHZZ	91506	14007-1P4	PIN, SPRING	2
7	PAHZZ	81349	M39003-01-2608	CAP, FXD, ELECTLT	5
8	PAHZZ	81349	M39003/01-2526	CAP, FXD, ELECTLT	1
9	PAHZZ	81349	M39014/02-1270	CAP, FXD, CER	20
10	PAHZZ	81349	M39014-02-1258	CAP, FXD, CER	1
11	PAHZZ	81349	M39010/02-AIR0KP	COIL, RADIO FREQUENCY	1
12	PAHZZ	81349	JANTX1N4622	SEMICONDUCTOR DEVICE, DIODE	2
13	PAHZZ	81349	JANTX1N4148	SEMICONDUCTOR DEVICE, DIODE	3
14	PAHZZ	27014	LH0002H/883B	MICROCKT, LIN	2
15	PAHZZ	81349	M38510/10101BGC	MICROCKT, LIN	2
16	PAHZZ	07263	96L02DMQB	MICROCKT, DGTL	2
17	PAHZZ	81349	M38510/30009BCX	MICROCKT, DGTL	3
18	PAHZZ	01295	SNJ54L193J	MICROCKT, DGTL	7
19	PAHZZ	81349	M38510-02105BCB	MICROCKT, DGTL	1
20	PAHZZ	81349	M38510/02003BCB	MICROCKT, DGTL	1
21	PAHZZ	81349	M38510/02005BCB	MICROCKT, DGTL	2
22	PAHZZ	81349	RCR20G221JP	RES, FXD, CMPSN	4
23	PAHZZ	81349	RCR07G390JP	RES, FXD, CMPSN	2
24	PAHZZ	81349	RCR05G103JP	RES, FXD, CMPSN	2
25	PAHZZ	81349	RCR05G393JP	RES, FXD, CMPSN	1
26	PAHZZ	81349	RCR05G101JP	RES, FXD, CMPSN	4
27	PAHZZ	81349	RCR05G104JP	RES, FXD, CMPSN	1
28	PAHZZ	81349	RCR05G273JP	RES, FXD, CMPSN	3
29	PAHZZ	81349	RCR07G471JP	RES, FXD, CMPSN	4
30	PAHZZ	81349	RCR05G472JP	RES, FXD, CMPSN	1
31	PAHZZ	81349	RCR05G362JP	RES, FXD, CMPSN	1
32	PAHZZ	81349	RCR05G432JP	RES, FXD, CMPSN	1
33	PAHZZ	81349	JANTX2N2222A	TRANSISTOR	2

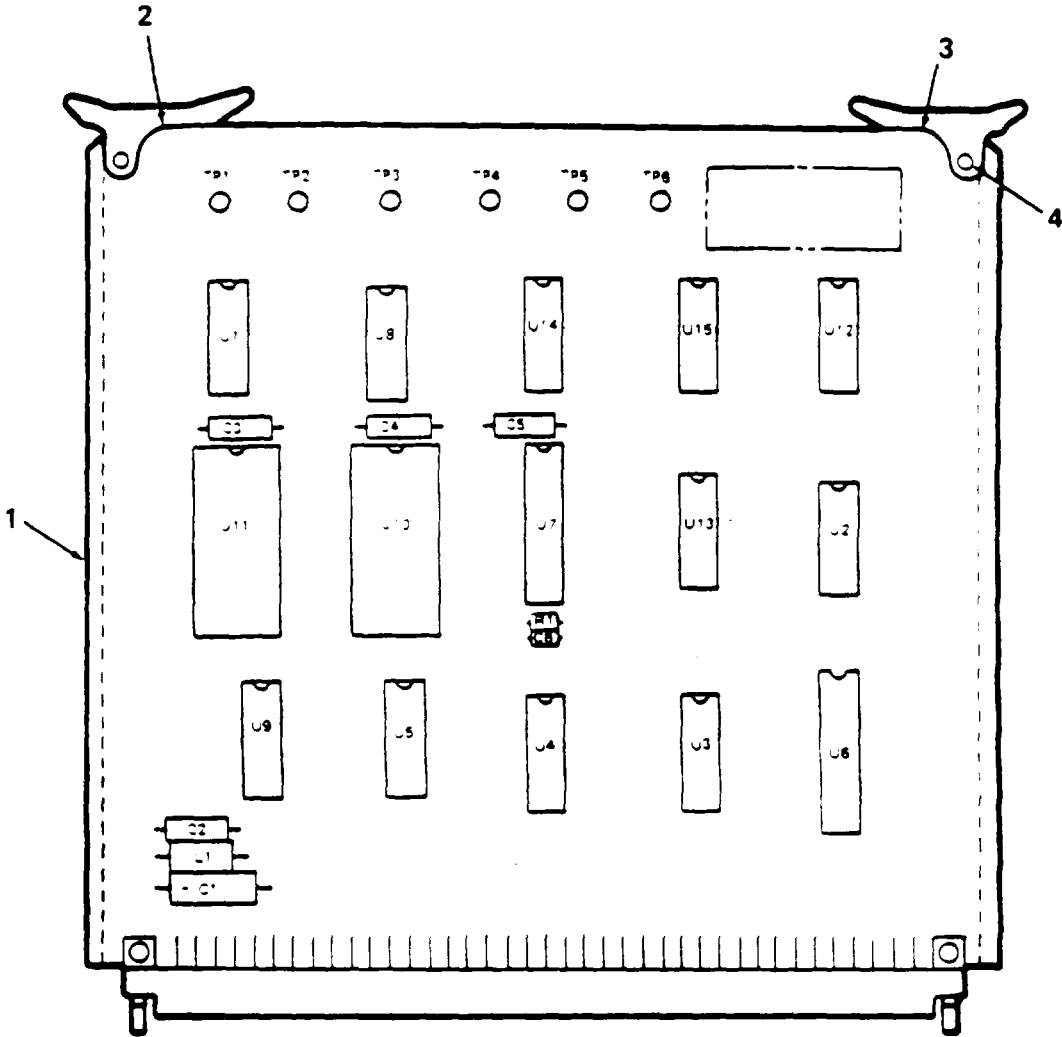

FIGURE 1-6. Memory CCA A6 (Sheet 1 of 2)

LEGEND

REF	ITEM	REF	ITEM	REF	ITEM	REF	ITEM	REF	ITEM	REF	ITEM
C1	10										
C2	8										
C3	8										
C4	8										
C5	8										
C6	9										
L1	23										
P1	5										
R1	11										
TP1	7										
TP2	7										
TP3	7										
TP4	7										
TP5	7										
TP6	7										
U1	16										
U2	18										
U3	15										
U4	15										
U5	15										
U6	20										
U7	19										
U8	17										
U9	17										
U10	21										
U11	21										
U12	12										
U13	14										
U14	13										
U15	12										

FIGURE 1-6. Memory CCA A6 (Sheet 2 of 2)

FIGURE: 1- 6

ITEM	SMR	CAGE	PART NUMBER	DESCRIPTION	QTY
1	XA	57958	C5135460-1	PRINTED WRG B0	1
2	XDDZZ	91506	14009-1P14	RTNR-EJCTR, CARD (RED)	1
3	XDDZZ	91506	14009-1P12	RTNR-EJCTR,CARD (WHITE)	1
4	XDDZZ	91506	14007-1P4	PIN, SPRING	2
5	XDHZZ	31413	M1001-00844FH	CONN, PLUG	1
6	XDDZZ	96906	MS20470AD2-5	RIVET, SOLID	2
7	XDDZZ	81349	SE16XC01	TERMINAL, STUD	6
8	PAHZZ	81349	M39014/05-2291	CAP, FXD, CER	4
9	PAHZZ	81349	M39014/05-2219	CAP, FXD, CER	1
10	PAHZZ	81349	M39003-01-2511	CAP, FXD, ELECTLT	1
11	PAHZZ	81349	RLR05C1000FP	RES, FXD, FILM	1
12	PAHZZ	81349	M38510-30001BCX	MICROCKT, DGTL	2
13	PAHZZ	81349	M38510-30003BCX	MICROCKT, DGTL	1
14	PAHZZ	81349	M38510-30005BCX	MICROCKT, DGTL	1
15	PAHZZ	81349	M38510/30903BEX	MICROCKT, DGTL	3
16	PAHZZ	81349	M38510/30605BCX	MICROCKT, DGTL	1
17	PAHZZ	81349	M38510-30106BEX	MICROCKT, DGTL	2
18	PAHZZ	81349	M38510/31508BEX	MICROCKT, DGTL	1
19	PAHZZ	81349	M38510/32401BRX	MICROCKT, DGTL	1
20	PAHZZ	81349	M38510/32403BRX	MICROCKT, DGTL	1
21	PAHZZ	14933	8103908JB	MICROCKT, DGTL	2
22	PAHZZ	81349	M39010/02-AIR0KP	COIL, RADIO FREQUENCY	1



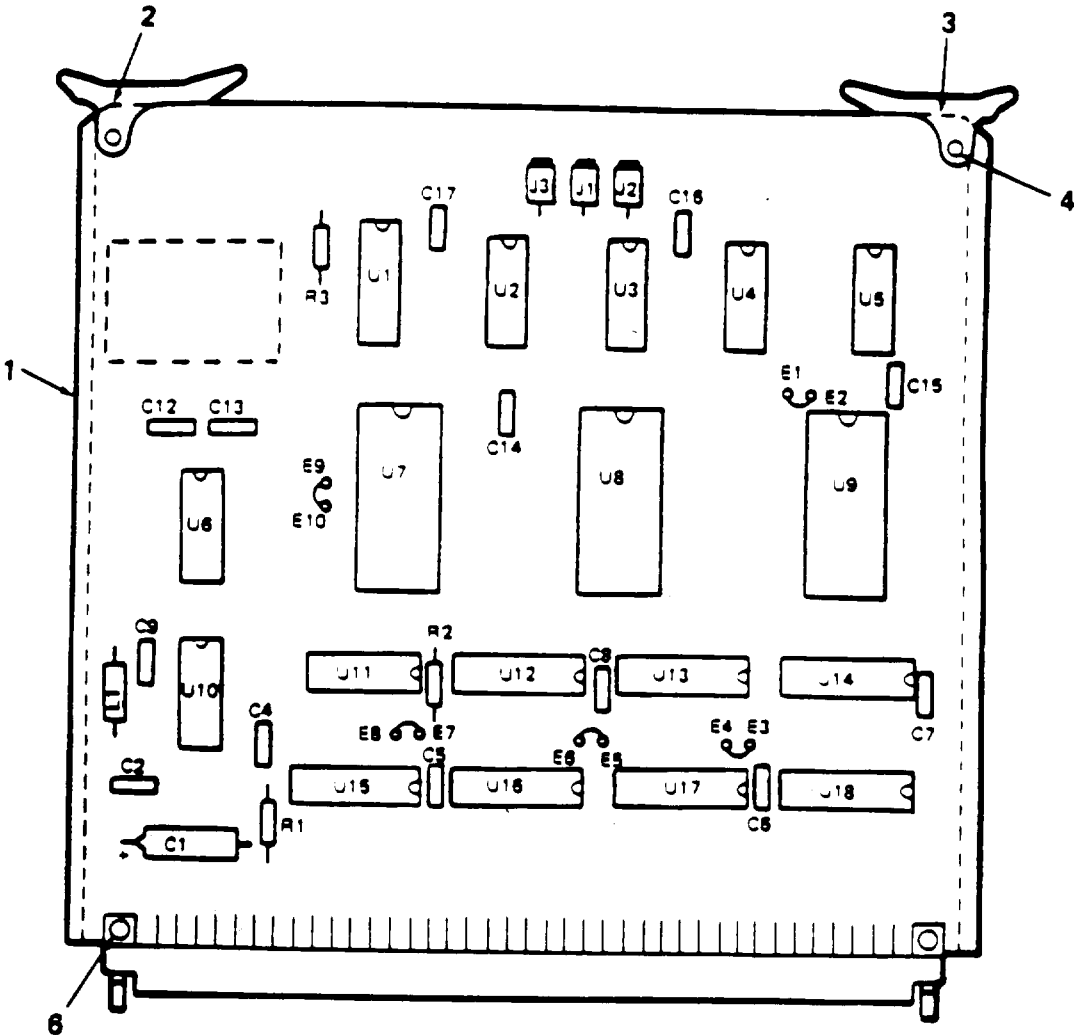

FIGURE 1-7. RCU Interface CCA A7 (Sheet 1 of 2)

LEGEND

REF	ITEM	REF	ITEM	REF	ITEM	REF	ITEM	REF	ITEM	REF	ITEM
C1	7										
C2	8										
C4	8										
C5	8										
C6	8										
C7	8										
C8	8										
C9	9										
C12	9										
C13	9										
C14	8										
C15	8										
C16	8										
C17	8										
J1	19										
J2	19										
J3	19										
L1	10										
P1	5										
R1	17										
R2	17										
R3	18										
U1	11										
U2	14										
U3	14										
U4	14										
U5	14										
U6	15										
U7	12										
U8	12										
U9	12										
U10	15										
U11	16										
U12	13										
U13	13										
U14	13										
U15	13										
U16	13										
U17	13										
U18	13										

FIGURE 1-7. RCU Interface CCA A7 (Sheet 2 of 2).

FIGURE: 1- 7

ITEM	SMR	CAGE	PART NUMBER	DESCRIPTION	QTY
1	XA	28815	12-123623-1	PRINTED WRG B0	1
2	XDHZZ	91506	14009-1P14	RTNR-EJCTR, CARD (RED)	1
3	XDHZZ	91506	14009-1P12	RTNR-EJCTR, CARD (WHITE)	1
4	XDHZZ	91506	14007-1P4	PIN, SPRING	2
5	XDHZZ	31413	M1001-00844-GA	CONN, RCPT	1
6	XDHZZ	96906	MS20470AD2-5	RIVET, SOLID	2
7	PAHZZ	81349	M39003/01-2526	CAP, FXD, ELECTLT	1
8	PAHZZ	81349	M39014-02-1270	CAP, FXD, CER	10
9	PAHZZ	81349	M39014-02-1411	CAP, FXD, CER	3
10	PAHZZ	81349	M39010/02-A1R0KP	COIL, RADIO FREQUENCY	1
11	PAHZZ	07263	93L28DMQB	MICROCKT, DGTL	1
12	PAHZZ	07263	93L08DMQB	MICROCKT, DGTL	3
13	PAHZZ	81349	M38510/30903BEX	MICROCKT, DGTL	7
14	PAHZZ	81349	M38510/00903BCB	MICROCKT, DGTL	4
15	PAHZZ	01295	SNJ55182J	MICROCKT, DGTL	2
16	PAHZZ	81349	M38510-02701BCB	MICROCKT, DGTL	1
17	PAHZZ	81349	RCR07G102JP	RES, FXD, CMPSN	2
18	PAHZZ	81349	RCR07G471JP	RES, FXD, CMPSN	1
19	XDHZZ	71279	450-3422-01-03	JACK, TIP	3

29/(30 blank)

**Section III. SPECIAL TOOLS LIST**

NO SPECIAL TOOLS REQUIRED

**31/(32 blank)**

## SECTION IV: CROSS REFERENCE INDEXES

## FIGURE AND ITEM MIER INDEX

FIGURE NUMBER	ITEM NUMBER	NATIONAL STOCK NUMBER	CAGE	PART NUMBER
1-1	1		15942	1951-1-5023-2
1-1	2		15942	1951-1-5023-501
1-1	3	5865-01-066-1618	15942	1951-1-4204-1
1-1	4	5305-00-054-5648	96906	MS51957-14
1-1	5	5310-00-933-8118	96906	MS35338-135
1-1	6	5310-00-595-6211	96906	MS15795-803
1-1	7		15942	1951-1-4264-1
1-1	8	5865-01-066-3234	28815	10-123614-1
1-1	9		57958	C5135457-1
1-1	10	5865-01-066-1646	28815	10-123594-1
1-1	11	5811-01-102-9136	28815	10-123624-2
1-1	12	5865-01-066-1644	15942	1951-1-4137-1
1-1	13	5865-01-066-1647	28815	10-123584-1
1-1	14	5865-01-248-7492	15942	1951-1-4873-2
1-1	15		30885	10-791806
1-1	16	5811-00-P03-0773	15942	1951-1-4021-1
1-1	17	5811-00-P03-9196	15942	1951-1-4021-501
1-1	18	5310-00-595-6761	96906	MS15795-802
1-1	19		15942	1951-1-3297-1
1-1	20	5310-00-208-3786	80205	NAS671C4L
1-1	21	5305-00-225-6400	96906	MS24693-C3
1-1	22	5865-01-066-1619	15942	1951-1-4133-1
1-1	23	5865-01-066-1621	28815	10-123525-1
1-1	24	5865-01-071-1866	28815	10-123495-1
1-1	25	5865-01-066-1620	15942	1951-1-4128-1
1-1	26	5865-01-066-1617	28815	10-123505-1
1-1	27	5865-01-066-1616	28815	10-123545-1
1-1	28	5865-01-066-7363	28815	10-123555-1
1-1	29	5305-00-054-5650	96906	MS51957-16
1-1	30	5305-00-056-9961	96906	MS24693C4
1-1	31	5310-00-073-9190	15653	MK1301-04
1-1	32	5320-00-117-6010	96906	MS20426AD2-3
1-1	33		15942	1951-1-4083-1
1-1	34		15942	1951-1-4083-501
1-1	35		15942	1951-1-3040-1
1-1	36	5999-01-054-0583	18915	35-7B2-10-3
1-1	37	5320-00-534-0609	96906	MS20470AD2-2
1-1	38		15942	1951-1-4083-2
1-1	39		15942	1951-1-4083-502
1-1	40	5340-00-759-6438	46384	FE-832
1-1	41	5305-00-054-6669	96906	MS51957-44
1-1	42	3460-00-876-2922	94867	HDH-4
1-1	43		15942	1951-1-4195-1

## FIGURE AND ITEM NUMBER INDEX

FIGURE NUMBER	ITEM NUMBER	NATIONAL STOCK NUMBER	CAGE	PART NUMBER
1-2	1	5935-01-056-3253	96906	MS27508E16F8P
1-2	2	4920-00-255-1371	12436	A24514-001
1-2	3	5940-00-682-2477	96906	MS77068-1
1-2	4		06090	TMS1/4-9
1-3	1		28815	12-123583-1
1-3	2	5998-00-605-7936	91506	14009-1P12
1-3	3	5998-01-028-6070	91506	14009-1P14
1-3	4	5999-01-068-9564	91506	14007-1P4
1-3	5	5935-01-064-6817	31413	M1001-00844-BA
1-3	6	5320-00-243-8357	96906	MS20470AD2-5
1-3	7	5910-00-072-7647	81349	M39003/01-2526
1-3	8	5910-00-113-5499	81349	M39014-02-1270
1-3	9	5950-01-064-6335	81349	M39010/02-A1R0KP
1-3	10	5905-00-568-7510	81349	RCR05G472JP
1-3	11	5905-00-120-9154	81349	RCR07G471JP
1-3	12	5962-01-028-6967	01295	SNC54184J
1-3	13	5962-00-262-0652	01295	SNJ54L193J
1-3	14	5962-00-390-8014	81349	M38510/02001BCB
1-3	15	5962-00-390-7970	81349	M38510/02005BCB
1-4	1		28815	1951-1-4136-1
1-4	2	5998-01-028-6070	91506	14009-IP14
1-4	3	5998-00-605-7936	91506	14009-IP12
1-4	4	5999-01-068-9564	91506	14007-1P4
1-4	5	5935-01-064-7838	31413	M1001-00844-CA
1-4	6	5320-00-243-8357	96906	MS20470AD2-5
1-4	7	5935-00-988-6438	71279	450-3422-01-03
1-4	8	5910-01-221-5145	81349	M39014/01-1495
1-4	9	5910-00-072-7647	81349	M39003/01-2526
1-4	10	5910-00-996-2259	81349	M39003-01-2608
1-4	11	5910-01-254-0361	81349	M39003/01-2523
1-4	12	5910-00-113-5499	81349	M39014/02-1270
1-4	13	5910-00-113-5277	81349	M39014/01-1483
1-4	14	5910-01-087-6360	81349	RCMR03F101J0YP
1-4	15	5910-01-093-6320	81349	RCMR03F271J0YP
1-4	16	5910-00-266-8403	81349	M39014-02-1411
1-4	17	5961-00-494-4915	81349	JANTX1N4148
1-4	18		81349	M39010/0281R0KR
1-4	19	5962-01-049-0349	81349	M38510/10901BGX
1-4	20	5962-01-131-6195	07263	96L02DMQB
1-4	21	5962-00-369-7606	81349	M38510-02105BCB
1-4	22	5962-00-257-9226	81349	M38510-02701BCB
1-4	23	5962-00-390-7958	81349	M38510-02004BCB
1-4	24	5962-00-390-7970	81349	M38510/02005BCB

## FIGURE AND ITEM NUMBER INDEX

FIGURE NUMBER	ITEM NUMBER	NATIONAL STOCK NUMBER	CAGE	PART NUMBER
1-4	25	5962-01-209-6069	81349	M38510/30302BCX
1-4	26	5962-01-107-6925	27014	LH0002H/883B
1-4	27	5962-01-016-7260	3437L	HM1-7611-8
1-4	28	5905-00-141-1855	81349	RCR07G100JP
1-4	29	5905-00-120-9154	81349	RCR07G471JP
1-4	30	5905-00-110-7622	81349	RCR07G682JP
1-4	31	5905-00-141-2421	81349	RCR07G823JP
1-4	32	5905-00-116-8556	81349	RCR07G223JP
1-4	33	5905-00-400-4528	81349	RCR07G124JP
1-4	34	5905-00-141-0717	81349	RCR07G473JP
1-4	35	5905-00-110-0388	81349	RCR07G104JP
1-4	36	5905-00-114-5339	81349	RCR07G154JP
1-4	37	5905-00-114-0711	81349	RCR07G472JP
1-4	38	5905-00-110-7620	81349	RCR07G102JP
1-4	39	5905-00-106-9344	81349	RCR20G101JP
1-4	40	5905-01-077-9821	81349	M39015/3-010XP-
1-4	41	5962-01-058-1539	81349	M38510/30102BCX
1-5	1		28815	12-123623-1
1-5	2		28815	M1001-00844-DA
1-5	3	5320-00-243-8357	96906	MS20470AD2-5
1-5	4	5998-01-028-6070	91506	14009-1P14
1-5	5	5998-00-605-7936	91506	14009-1P12
1-5	6	5999-01-068-9564	91506	14007-1P4
1-5	7	5910-00-996-2259	81349	M39003-01-2608
1-5	8	5910-00-072-7647	81349	M39003/01-2526
1-5	9	5910-00-113-5499	81349	M39014/02-1270
1-5	10	5910-00-115-8456	81349	M39014-02-1258
1-5	11	5950-01-064-6335	81349	M39010/02-A1R0KP
1-5	12	5961-01-026-8942	81349	JANTX1N4622
1-5	13	5961-00-494-4915	81349	JANTXIN4148
1-5	14	5962-01-107-6925	27014	LH0002H/883B
1-5	15	5962-00-167-6330	81349	M38510/10101BGC
1-5	16	5962-01-131-6195	07263	96L02DMQB
1-5	17	5962-01-026-6055	81349	M38510/30009BCX
1-5	18	5962-00-262-0652	01295	SNJ54L193J
1-5	19	5962-00-369-7606	81349	M38510-02105BCB
1-5	20	5962-00-396-2262	81349	M38510/02003BCB
1-5	21	5962-00-390-7970	81349	M38510/02005BCB
1-5	22	5905-00-104-8350	81349	RCR20G221JP
1-5	23		81349	RCR07G390JP
1-5	24	5905-00-568-7712	81349	RCR05G1003JP
1-5	25	5905-00-519-0510	81349	RCR05G393JP
1-5	26	5905-00-568-7225	81349	RCR0SGI01JP
1-5	27	5905-00-519-0559	81349	RCR05G104JP

## FIGURE AND ITEM NUMBER INDEX

FIGURE NUMBER	ITEM NUMBER	NATIONAL STOCK NUMBER	CAGE	PART NUMBER
1-5	28	5905-00-141-1761	81349	RCR05G273JP
1-5	29	5905-00-120-9154	81349	RCR07G471JP
1-5	30	5905-00-568-7510	81349	RCR05G472JP
1-5	31	5905-00-125-0884	81349	RCR05G362JP
1-5	32	5905-00-125-0886	81349	RCR05G432JP
1-5	33	5961-00-858-3826	81349	JANTX2N2222A
1-6	1		57958	C5135460-1
1-6	2	5998-01-028-6070	91506	14009-1P14
1-6	3	5998-00-605-7936	91506	14009-1P12
1-6	4	5999-01-068-9564	91506	14007-1P4
1-6	5		31413	M1001-00844FH
1-6	6	5320-00-243-8357	96906	MS20470AD2-5
1-6	7	5940-00-082-5002	81349	SE16XC01
1-6	8	5910-00-113-5610	81349	M39014/05-2291
1-6	9	5910-00-113-5490	81349	M39014/05-2219
1-6	10	5910-00-996-0667	81349	M39003-01-2511
1-6	11	5905-01-159-7544	81349	RLR05C1000FP
1-6	12	5962-01-093-0110	81349	M38510-30001BCX
1-6	13	5962-01-091-8195	81349	M38510-30003BCX
1-6	14	5962-01-074-4122	81349	M38510-30005BCX
1-6	15	5962-01-050-0921	81349	M38510/30903BEX
1-6	16	5962-01-068-9593	81349	M38510/30605BCX
1-6	17	5962-01-096-4171	81349	M38510-30106BEX
1-6	18	5962-01-066-1153	81349	M38510/31508BEX
1-6	19	5962-01-093-8823	81349	M38510/32401BRX
1-6	20	5962-01-086-7634	81349	M38510/32403BRX
1-6	21	5962-01-215-0975	14933	8103908JB
1-6	22	5950-01-064-6335	81349	M39010/02-A1R0KP
1-7	1		28815	12-123623-1
1-7	2	5998-01-028-6070	91506	14009-1P14
1-7	3	5998-00-605-7936	91506	14009-1P12
1-7	4	5999-01-068-9564	91506	14007-1P4
1-7	5	5935-01-065-4186	31413	M1001-00844-GA
1-7	6	5320-00-243-8357	96906	MS20470AD2-5
1-7	7	5910-00-072-7647	81349	M39003/01-2526
1-7	8	5910-00-113-5499	81349	M39014-02-1270
1-7	9	5910-00-266-8403	81349	M39014-02-1411
1-7	10	5950-01-064-6335	81349	M39010/02-A1R0KP
1-7	11	5962-01-042-9794	07263	93L28DMQB
1-7	12	5962-01-032-6842	07263	93L08DMQB
1-7	13	5962-01-050-0921	81349	M38510/30903BEX
1-7	14	5962-00-173-9776	81349	M38510/009038CB
		<b>36</b>		



FIGURE AND ITEM NUMBER INDEX

FIGURE NUMBER	ITEM NUMBER	NATIONAL STOCK NUMBER	CAGE	PART NUMBER
1-7	15	5962-01-086-0293	01295	SNJ55182J
1-7	16	5962-00-257-9226	81349	M38510-02701BCB
1-7	17	5905-00-110-7620	81349	RCR07G102JP
1-7	18	5905-00-120-9154	81349	RCR07G471JP
1-7	19	5935-00-988-6438	71279	450-3422-01-03

NATIONAL STOCK NUMBER INDEX

NATIONAL STOCK NUMBER	FIGURE NO.	ITEM NO.	NATIONAL STOCK NUMBER	FIGURE NO.	ITEM NO.
	1-5	23	5905-00-120-9154	1-5	29
	1-1	83	5905-00-120-9154	1-3	11
	1-1	34	5905-00-120-9154	1-7	18
	1-1	35	5905-00-120-9154	1-4	29
	1-1	2	5905-00-125-0884	1-5	31
	1-1	33	5905-00-125-0886	1-5	32
	1-7	1	5905-00-141-0717	1-4	34
	1-2	4	5905-00-141-1761	1-5	28
	1-4	1	5905-00-141-1855	1-4	28
	1-1	7	5905-00-141-2421	1-4	31
	1-5	1	5962-00-167-6330	1-5	15
	1-1	9	5962-00-173-9776	1-7	14
	1-5	2	5310-00-208-3786	1-1	20
	1-1	19	5305-00-225-6400	1-1	21
	1-6	1	5320-00-243-8357	1-6	6
	1-6	5	5320-00-243-8357	1-3	6
	1-3	1	5320-00-243-8357	1-7	6
	1-1	15	5320-00-243-8357	1-5	3
	1-1	1	5320-00-243-8357	1-4	6
	1-4	18	4920-00-255-1371	1-2	2
	1-1	39	5962-00-257-9226	1-4	22
	1-1	38	5962-00-257-9226	1-7	16
5305-00-054-5648	1-1	4	5962-00-262-0652	1-5	18
5305-00-054-5650	1-1	29	5962-00-262-0652	1-3	13
5305-00-054-6669	1-1	41	5910-00-266-8403	1-4	16
5305-00-056-9961	1-1	30	5910-00-266-8403	1-7	9
5910-00-072-7647	1-5	8	5962-00-369-7606	1-4	21
5910-00-072-7647	1-7	7	5962-00-369-7606	1-5	19
5910-00-072-7647	1-3	7	5962-00-390-7958	1-4	23
5910-00-072-7647	1-4	9	5962-00-390-7970	1-4	24
5310-00-073-9190	1-1	31	5962-00-390-7970	1-5	21
5940-00-082-5002	1-6	7	5962-00-390-7970	1-3	15
5905-00-104-8350	1-5	22	5962-00-390-8014	1-3	14
5905-00-106-9344	1-4	39	5962-00-396-2262	1-5	20
5905-00-110-0388	1-4	35	5905-00-400-4528	1-4	33
5905-00-110-7620	1-7	17	5961-00-494-4915	1-5	13
5905-00-110-7620	1-4	38	5961-00-494-4915	1-4	17
5905-00-110-7622	1-4	30	5905-00-519-0510	1-5	25
5910-00-113-5277	1-4	13	5905-00-519-0559	1-5	27
5910-00-113-5490	1-6	9	5320-00-534-0609	1-1	37
5910-00-113-5499	1-4	12	5905-00-568-7225	1-5	26
5910-00-113-5499	1-3	8	5905-00-568-7510	1-3	10
5910-00-113-5499	1-7	8	5905-00-568-7510	1-5	30
5910-00-113-5499	1-5	9	5905-00-568-7712	1-5	24
5910-00-113-5610	1-6	8	5310-00-595-6211	1-1	6
5905-00-114-0711	1-4	37	5310-00-595-6761	1-1	18
5905-00-114-5339	1-4	36	5998-00-605-7936	1-3	2
5910-00-115-8456	1-5	10	5998-00-605-7936	1-7	3
5905-00-116-8556	1-4	32	5998-00-605-7936	1-6	3
5320-00-117-6010	1-1	32	5998-00-605-7936	1-5	5

## NATIONAL STOCK NUMBER INDEX

NATIONAL STOCK NUMBER	FIGURE NO.	ITEM NO.	NATIONAL STOCK NUMBER	FIGURE NO.	ITEM NO.
5998-00-605-7936	1-4	3	5999-01-068-9564	1-5	6
5940-00-682-2477	1-2	3	5999-01-068-9564	1-3	4
5430-00-759-6438	1-1	40	5999-01-068-9564	1-6	4
5961-00-858-3826	1-5	33	5999-01-068-9564	1-7	4
3460-00-876-2922	1-1	42	5962-01-068-9593	1-6	16
5310-00-933-8118	1-1	5	5865-01-071-1866	1-1	24
5935-00-988-6438	1-7	19	5962-01-074-4122	1-6	14
5935-00-988-6438	1-4	7	5905-01-077-9821	1-4	40
5910-00-996-0667	1-6	10	5962-01-086-0293	1-7	15
5910-00-996-2259	1-5	7	5962-01-086-7634	1-6	20
5910-00-996-2259	1-4	10	5910-01-087-6360	1-4	14
5811-00-P03-0773	1-1	16	5962-01-091-8195	1-6	13
5811-00-P03-9196	1-1	17	5962-01-093-0110	1-6	12
5962-01-016-7260	1-4	27	5910-01-093-6320	1-4	15
5962-01-026-6055	1-5	17	5962-01-093-8823	1-6	19
5961-01-026-8942	1-5	12	5962-01-096-4171	1-6	17
5998-01-028-6070	1-6	2	5811-01-102-9136	1-1	11
5998-01-028-6070	1-7	2	5962-01-107-6925	1-4	26
5998-01-028-6070	1-3	3	5962-01-107-6925	1-5	14
5998-01-028-6070	1-4	2	5962-01-131-6195	1-4	20
5998-01-028-6070	1-5	4	5962-01-131-6195	1-5	16
5962-01-028-6967	1-3	12	5905-01-159-7544	1-6	11
5962-01-032-6842	1-7	12	5962-01-209-6069	1-4	25
5962-01-042-9794	1-7	11	5962-01-215-0975	1-6	21
5962-01-049-0349	1-4	19	5910-01-221-5145	1-4	8
5962-01-050-0921	1-6	15	5865-01-248-7492	1-1	14
5962-01-050-0921	1-7	13	5910-01-254-0361	1-4	11
5999-01-054-0583	1-1	36			
5935-01-056-3253	1-2	1			
5962-01-058-1539	1-4	41			
5950-01-064-6335	1-5	11			
5950-01-064-6335	1-3	9			
5950-01-064-6335	1-6	22			
5950-01-064-6335	1-7	10			
5935-01-064-6817	1-3	5			
5935-01-064-7838	1-4	5			
5935-01-065-4186	1-7	5			
5962-01-066-1153	1-6	18			
5865-01-066-1616	1-1	27			
5865-01-066-1617	1-1	26			
5865-01-066-1618	1-1	3			
5865-01-066-1619	1-1	22			
5865-01-066-1620	1-1	25			
5865-01-066-1621	1-1	23			
5865-01-066-1644	1-1	12			
5865-01-066-1646	1-1	10			
5865-01-066-1647	1-1	13			
5865-01-066-3234	1-1	8			
5865-01-066-7363	1-1	28			
5999-01-068-9564	1-4	4			

REFERENCE DESIGNATOR INDEX

FIG NO.	ITEM NO.	NATIONAL STOCK NUMBER	FIG. NO.	ITEM NO.	NATIONAL STOCK NUMBER
1-1	1		1-3	1	
1-1	2		1-3	2	5998-00-605-7936
1-1	3	5865-01-066-1618	1-3	3	5998-01-028-6070
1-1	4	5305-00-054-5648	1-3	4	5999-01-068-9564
1-1	5	5310-00-933-8118	1-3	5	5935-01-064-6817
1-1	6	5310-00-595-6211	1-3	6	5320-00-243-8357
1-1	7		1-3	7	5910-00-072-7647
1-1	8	5865-01-066-3234	1-3	8	5910-00-113-5499
1-1	9		1-3	9	5950-01-064-6335
1-1	10	5865-01-066-1646	1-3	10	5905-00-568-7510
1-1	11	5811-01-102-9136	1-3	11	5905-00-120-9154
1-1	12	5865-01-066-1644	1-3	12	5962-01-028-6967
1-1	13	5865-01-066-1647	1-3	13	5962-00-262-0652
1-1	14	5865-01-248-7492	1-3	14	5962-00-390-8014
1-1	15		1-3	15	5962-00-390-7970
1-1	16	5811-00-P03-0773			
1-1	17	5811-00-P03-9196			
1-1	18	5310-00-595-6761	1-4	1	
1-1	19		1-4	2	5998-01-028-6070
1-1	20	5310-00-208-3786	1-4	3	5998-00-605-7936
1-1	21	5305-00-225-6400	1-4	4	5999-01-068-9564
1-1	22	5865-01-066-1619	1-4	5	5935-01-064-7838
1-1	23	5865-01-066-1621	1-4	6	5320-00-243-8357
1-1	24	5865-01-071-1866	1-4	7	5935-00-988-6438
1-1	25	5865-01-066-1620	1-4	3	5910-01-221-5145
1-1	26	5865-01-066-1617	1-4	9	5910-00-072-7647
1-1	27	5865-01-066-1616	1-4	10	5910-00-996-2259
1-1	28	5865-01-066-7363	1-4	i1	5910-01-254-0361
1-1	29	5305-00-054-5650	1-4	12	5910-00-113-5499
1-1	30	5305-00-056-9961	1-4	13	5910-00-113-5277
1-1	31	5310-00-073-9190	1-4	14	5910-01-087-6360
1-1	32	5320-00-117-6010	1-4	15	5910-01-093-6320
1-1	33		1-4	16	5910-00-266-8403
1-1	34		1-4	17	5961-00-494-4915
1-1	35		1-4	18	
1-1	36	5999-01-054-0583	1-4	19	5962-01-049-0349
1-1	37	5320-00-534-0609	1-4	20	5962-01-131-6195
1-1	38		1-4	21	5962-00-369-7606
1-1	39		1-4	22	5962-00-257-9226
1-1	40	5340-00-759-6438	1-4	23	5962-00-390-7958
1-1	41	5305-00-054-6669	1-4	24	5962-00-390-7970
1-1	42	3460-00-876-2922	1-4	25	5962-01-209-6069
1-1	43		1-4	26	5962-01-107-6925
1-1	27	5962-01-016-7260			
1-2	1	5935-01-056-3253	1-4	28	5905-00-141-1855
1-2	2	4920-00-255-1371	1-4	29	5905-00-120-9154
1-2	3	5940-00-682-2477	1-4	30	5905-00-110-7622
1-2	4		1-4	31	5905-00-141-2421
1-4	32	5905-00-116-8556			
1-4	33	5905-00-400-4528			

## REFERENCE DESIGNATOR INDEX

FIG NO.	ITEM NO.	NATIONAL STOCK NUMBER	FIG. NO.	ITEM NO.	NATIONAL STOCK NUMBER
1-4	34	5905-00-141-0717	1-6	1	
1-4	35	5905-00-110-0388	1-6	2	5998-01-028-6070
1-4	36	5905-00-114-5339	1-6	3	5998-00-605-7936
1-4	37	5905-00-114-0711	1-6	4	5999-01-068-9564
1-4	38	5905-00-110-7620	1-6	5	
1-4	39	5905-00-106-9344	1-6	6	5320-00-243-8357
1-4	34	5905-00-141-0717	1-6	7	5940-00-082-5002
1-4	35	5905-00-110-0388	1-6	8	5910-00-113-5610
1-4	36	5905-00-114-5339	1-6	9	5910-00-113-5490
1-4	37	5905-00-114-0711	1-6	10	5910-00-996-0667
1-4	38	5905-00-110-7620	1-6	11	5905-01-159-7544
1-4	39	5905-00-106-9344	1-6	12	5962-01-093-0110
1-4	40	5905-01-077-9821	1-6	13	5962-01-091-8195
1-4	41	5962-01-058-1539	1-6	14	5962-01-074-4122
1-6	15	5962-01-050-0921			
1-6	16	5962-01-068-9593			
1-5	1		1-6	17	5962-01-096-4171
1-5	2		1-6	18	5962-01-066-1153
1-5	3	5320-00-243-8357	1-6	19	5962-01-093-8823
1-5	4	5998-01-028-6070	1-6	20	5962-01-086-7634
1-5	5	5998-00-605-7936	1-6	21	5962-01-215-0975
1-5	6	5999-01-068-9564	1-6	22	5950-01-064-6335
1-5	7	5910-00-996-2259			
1-5	8	5910-00-072-7647			
1-5	9	5910-00-113-5499	1-7	1	
1-5	10	5910-00-115-8456	1-7	2	5998-01-028-6070
1-5	11	5950-01-064-6335	1-7	3	5998-00-605-7936
1-5	12	5961-01-026-8942	1-7	4	5999-01-068-9564
1-5	13	5961-00-494-4915	1-7	5	5935-01-065-4186
1-5	14	5962-01-107-6925	1-7	6	5320-00-243-8357
1-5	15	5962-00-167-6330	1-7	7	5910-00-072-7647
1-5	16	5962-01-131-6195	1-7	8	5910-00-113-5499
1-5	17	5962-01-026-6055	1-7	9	5910-00-266-8403
1-5	18	5962-00-262-0652	1-7	10	5950-01-064-6335
1-5	19	5962-00-369-7606	1-7	11	5962-01-042-9794
1-5	20	5962-00-396-2262	1-7	12	5962-01-032-6842
1-5	21	5962-00-390-7970	1-7	13	5962-01-050-0921
1-5	22	5905-00-104-8350	1-7	14	5962-00-173-9776
1-5	23		1-7	15	5962-01-086-0293
1-5	24	5905-00-568-7712	1-7	16	5962-00-257-9226
1-5	25	5905-00-519-0510	1-7	17	5905-00-110-7620
1-5	26	5905-00-568-7225	1-7	18	5905-00-120-9154
1-5	27	5905-00-519-0559	1-7	19	5935-00-988-6438
1-5	28	5905-00-141-1761			
1-5	29	5905-00-120-9154			
1-5	30	5905-00-568-7510			
1-5	31	5905-00-125-0884			
1-5	32	5905-00-125-0886			
1-5	33	5961-00-858-3826			

## PART NUMBER INDEX

CAGE	PART NUMBER	NATIONAL STOCK NUMBER	FIGURE NUMBER	ITEM NUMBER
28815	10-123495-1	5865-01-071-1866	1-1	24
28815	10-123505-1	5865-01-066-1617	1-1	26
28815	10-123525-1	5865-01-066-1621	1-1	23
28815	10-123545-1	5865-01-066-1616	1-1	27
28815	10-123555-1	5865-01-066-7363	1-1	28
28815	10-123584-1	5865-01-066-1647	1-1	13
28815	10-123594-1	5865-01-066-1646	1-1	10
28815	10-123614-1	5865-01-066-3234	1-1	8
28815	10-123624-2	5811-01-102-9136	1-1	11
28815	12-123583-1		1-3	1
28815	12-123623-1		1-7	1
28815	12-123623-1		1-5	1
91506	14007-1P4	5999-01-068-9564	1-3	4
91506	14007-1P4	5999-01-068-9564	1-7	4
91506	14007-1P4	5999-01-068-9564	1-6	4
91506	14007-1P4	5999-01-068-9564	1-5	6
91506	14007-1P4	5999-01-068-9564	1-4	4
91506	14009-1P12	5998-00-605-7936	1-6	3
91506	14009-1P12	5998-00-605-7936	1-7	3
91506	14009-1P12	5998-00-605-7936	1-4	3
91506	14009-1P12	5998-00-605-7936	1-3	2
91506	14009-1P12	5998-00-605-7936	1-5	5
91506	14009-1P14	5998-01-028-6070	1-4	2
91506	14009-1P14	5998-01-028-6070	1-3	3
91506	14009-1P14	5998-01-028-6070	1-7	2
91506	14009-1P14	5998-01-028-6070	1-5	4
91506	14009-1P14	5998-01-028-6070	1-6	2
15942	1951-1-3040-1		1-1	35
15942	1951-1-3297-1		1-1	19
15942	1951-1-4021-1	5811-00-P03-0773	1-1	16
15942	1951-1-4021-501	5811-00-P03-9196	1-1	17
15942	1951-1-4083-1		1-1	33
15942	1951-1-4083-2		1-1	38
15942	1951-1-4083-501		1-1	34
15942	1951-1-4083-502		1-1	39
15942	1951-1-4128-1	5865-01-066-1620	1-1	25
15942	1951-1-4133-1	5865-01-066-1619	1-1	22
28815	1951-1-4136-1		1-4	1
15942	1951-1-4137-1	5865-01-066-1644	1-1	12
15942	1951-1-4195-1		1-1	43
15942	1951-1-4204-1	5865-01-066-1618	1-1	3
15942	1951-1-4264-1		1-1	7
15942	1951-1-4873-2	5865-01-248-7492	1-1	14
15942	1951-1-5023-2		1-1	1
15942	1951-1-5023-501		1-1	2
18915	35-7B2-10-3	5999-01-054-0583	1-1	36

## PART NUMBER INDEX

CAGE	PART NUMBER	NATIONAL STOCK NUMBER	FIGURE NUMBER	ITEM NUMBER
71279	450-3422-01-03	5935-00-988-6438	1-7	19
71279	450-3422-01-03	5935-00-988-6438	1-4	7
14933	8103908JB	5962-01-215-0975	1-6	21
07263	93L08DMQB	5962-01-032-6842	1-7	12
07263	93L28DMQB	5962-01-042-9794	1-7	11
07263	96L02DMQB	5962-01-131-6195	1-4	20
07263	96L02DMQB	5962-01-131-6195	1-5	16
12436	A24514-001	4920-00-255-1371	1-2	2
57958	C5135457-1		1-1	9
57958	C5135460-1		1-6	1
81349	CMR03F101J0YP	5910-01-087-6360	1-4	14
81349	CMR03F271J0YP	5910-01-093-6320	1-4	15
30885	D-791806		1-1	15
46384	FE-832	5340-00-759-6438	1-1	40
94867	HDH-4	3460-00-876-2922	1-1	42
34371	HM1-7611-8	5962-01-016-7260	1-4	27
81349	JANTX1N4148	5961-00-494-4915	1-4	17
81349	JANTX1N4148	5961-00-494-4915	1-5	13
81349	JANTX1N4622	5961-01-026-8942	1-5	12
81349	JANTX2N2222A	5961-00-858-3826	1-5	33
27014	LH0002H/883B	5962-01-107-6925	1-4	26
27014	LH0002H/883B	5962-01-107-6925	1-5	14
31413	M1001-00844-BA	5935-01-064-6817	1-3	5
31413	M1001-00844-CA	5935-01-064-7838	1-4	5
28815	M1001-00844-DA		1-5	2
31413	M1001-00844-GA	5935-01-065-4186	1-7	5
31413	M1001-00844FH		1-6	5
81349	M38510-02004BCB	5962-00-390-7958	1-4	23
81349	M38510-02105BCB	5962-00-369-7606	1-4	21
81349	M38510-02105BCB	5962-00-369-7606	1-5	19
81349	M38510-02701BCB	5962-00-257-9226	1-7	16
81349	M38510-02701BC8	5962-00-257-9226	1-4	22
81349	M38510-30001BCX	5962-01-093-0110	1-6	12
81349	M38510-30003BCX	5962-01-091-8195	1-6	13
81349	M38510-30005BCX	5962-01-074-4122	1-6	14
81349	M38510-30106BEX	5962-01-096-4171	1-6	17
81349	M38510/00903BCB	5962-00-173-9776	1-7	14
81349	M38510/02001BCB	5962-00-390-8014	1-3	14
81349	M38510/02003BCB	5962-00-396-2262	1-5	20
81349	M38510/02005BCB	5962-00-390-7970	1-4	24
81349	M38510/02005BCB	5962-00-390-7970	1-5	21
81349	M38510/02005BCB	5962-00-390-7970	1-3	15
81349	M38510/0011BGC	5962-00-167-6330	1-5	15
81349	M38510/10901BGX	5962-01-049-0349	1-4	19
81349	M38510/30009BCX	5962-01-026-6055	1-5	17
81349	M38510/30102BCX	5962-01-058-1539	1-4	41

## PART NUMBER INDEX

CAGE	PART NUMBER	NATIONAL STOCK NUMBER	FIGURE NUMBER	ITEM NUMBER
81349	M38510/30302BCX	5962-01-209-6069	1-4	25
81349	M38510/30605BCX	5962-01-068-9593	1-6	16
81349	M38510/30903BEX	5962-01-050-0921	1-7	13
81349	M38510/30903BEX	5962-01-050-0921	1-6	15
81349	M38510/31508BEX	5962-01-066-1153	1-6	18
81349	M38510/32401BRX	5962-01-093-8823	1-6	19
81349	M38510/32403BRX	5962-01-086-7634	1-6	20
81349	M39003-01-2511	5910-00-996-0667	1-6	10
81349	M39003-01-2608	5910-00-996-2259	1-5	7
81349	M39003-01-2608	5910-00-996-2259	1-4	10
81349	M39003/01-2523	5910-01-254-0361	1-4	11
81349	M39003/01-2526	5910-00-072-7647	1-3	7
81349	M39003/01-2526	5910-00-072-7647	1-5	8
81349	M39003/01-2526	5910-00-072-7647	1-4	9
81349	M39003/01-2526	5910-00-072-7647	1-7	7
81349	M39010/02-A1R0KP	5950-01-064-6335	1-6	22
81349	M39010/02-A1R0KP	5950-01-064-6335	1-3	9
81349	M39010/02-A1R0KP	5950-01-064-6335	1-7	10
81349	M39010/02-A1R0KP	5950-01-064-6335	1-5	11
81349	M39010/0281R0KR		1-4	18
81349	M39014-02-1258	5910-00-115-8456	1-5	10
81349	M39014-02-1270	5910-00-113-5499	1-5	9
81349	M39014-02-1270	5910-00-113-5499	1-3	8
81349	M39014-02-1270	5910-00-113-5499	1-4	12
81349	M39014-02-1270	5910-00-113-5499	1-7	8
81349	M39014-02-1411	5910-00-266-8403	1-7	9
81349	M39014-02-1411	5910-00-266-8403	1-4	16
81349	M39014/01-1483	5910-00-113-5277	1-4	13
81349	M39014/01-1495	5910-01-221-5145	1-4	8
81349	M39014/05-2219	5910-00-113-5490	1-6	9
81349	M39014/05-2291	5910-00-113-5610	1-6	8
81349	M39015/3-010XP	5905-01-077-9821	1-4	40
15653	MK1301-04	5310-00-073-9190	1-1	31
96906	MS15795-802	5310-00-595-6761	1-1	18
96906	MS15795-803	5310-00-595-6211	1-1	6
96906	MS20426AD2-3	5320-00-117-6010	1-1	32
96906	MS20470AD2-2	5320-00-534-0609	1-1	37
96906	MS20470AD2-5	5320-00-243-8357	1-4	6
96906	MS20470AD2-5	5320-00-243-8357	1-6	6
96906	MS20470A02-5	5320-00-243-8357	1-7	6
96906	MS20470AD2-5	5320-00-243-8357	1-3	6
96906	MS20470AD2-5	5320-00-243-8357	1-5	3
96906	MS24693-C3	5305-00-225-6400	1-1	21
96906	MS24693C4	5305-00-056-9961	1-1	30
96906	MS27508E16F8P	5935-01-056-3253	1-2	1
96906	MS35338-135	5310-00-933-8118	1-1	5



## PART NUMBER INDEX

CAGE	PART NUMBER	NATIONAL STOCK NUMBER	FIGURE NUMBER	ITEM NUMBER
96906	MS51957-14	5305-00-054-5648	1-1	4
96906	MS51957-16	5305-00-054-5650	1-1	29
96906	MS51957-44	5305-00-054-6669	1-1	41
96906	MS77068-1	5940-00-682-2477	1-2	3
80205	NAS671C4L	5310-00-208-3786	1-1	20
81349	RCR05G101JP	5905-00-568-7225	1-5	26
81349	RCR05G103JP	5905-00-568-7712	1-5	24
81349	RCR05G104JP	5905-00-519-0559	1-5	27
81349	RCR05G273JP	5905-00-141-1761	1-5	28
81349	RCR05G362JP	5905-00-125-0884	1-5	31
81349	RCR05G393JP	5905-00-519-0510	1-5	25
81349	RCR05G432JP	5905-00-125-0886	1-5	32
81349	RCR05G472JP	5905-00-568-7510	1-3	10
81349	RCR05G472JP	5905-00-568-7510	1-5	30
81349	RCR07G100JP	5905-00-141-1855	1-4	28
81349	RCR07G1002JP	5905-00-110-7620	1-7	17
81349	RCR07G102JP	5905-00-110-7620	1-4	38
81349	RCR07G104JP	5905-00-110-0388	1-4	35
81349	RCR07G124JP	5905-00-400-4528	1-4	33
81349	RCR07G154JP	5905-00-114-5339	1-4	36
81349	RCR07G223JP	5905-00-116-8556	1-4	32
81349	RCR07G390JP		1-5	23
81349	RCR07G471JP	5905-00-120-9154	1-5	29
81349	RCR07G471JP	5905-00-120-9154	1-7	18
81349	RCR07G471JP	5905-00-120-9154	1-4	29
81349	RCR07G471JP	5905-00-120-9154	1-3	11
81349	RCR07G472JP	5905-00-114-0711	1-4	37
81349	RCR07G473JP	5905-00-141-0717	1-4	34
81349	RCR07G682JP	5905-00-110-7622	1-4	30
81349	RCR07G823JP	5905-00-141-2421	1-4	31
81349	RCR20G101JP	5905-00-106-9344	1-4	39
81349	RCR20G221JP	5905-00-104-8350	1-5	22
81349	RLR05C1000FP	5905-01-159-7544	1-6	11
81349	SE16XC01	5940-00-082-5002	1-6	7
01295	SNC54184J	5962-01-028-6967	1-3	12
01295	SNJ54L193J	5962-00-262-0652	1-5	18
01295	SNJ54L193J	5962-00-262-0652	1-3	13
01295	SNJ55182J	5962-01-086-0293	1-7	15
06090	TMS1/4-9		1-2	4

45/(46 blank)

**APPENDIX A****REFERENCES****A-1. SCOPE.**

This appendix lists all forms, field manuals, technical manuals, and miscellaneous publications referenced in this manual.

**A-2. FORMS.**

DA Form 2028	Recommended Changes to Publications and Blank Forms
--------------	---

**A-3. ARMY REGULATIONS.**

AR 708-1	Cataloging and Supply Management Data
AR 750-1	Army Materiel Maintenance Policies

**A-4. SUPPLY BULLETINS.**

SB 708-42	Commercial and Government Entity (CAGE) Codes.
-----------	--

**A-1/(A-2 blank)**

## GLOSSARY

AG	Adjutant General
AMDF	Army Master Data File
AR	Army Regulation
ASSY	Assembly
BD	Board
BOI	Basis of Issue
CAGE	Commercial and Government Entity
CAP	Capacitor
CCA	Circuit Card Assembly
CER	Ceramic
CKT	Circuit
CMPSN	Composition
CONN	Connection
DA	Department of the Army
DGTL	Digital
DISCRIM	Discriminator
ECA	Electronic Component Assembly
EJCTR	Ejector
ELECTLT	Electrolytic
ELEK	Electronic
FIG	Figure
FXD	Fixed
GEN	Generator
GSKT	Gasket
IF	Intermediate Frequency
LIN	Linear
LOG	Logarithmic
MAC	Maintenance Allocation Chart
MICROCKT	Microcircuit
MTG	Mounting
NIIN	National Item Identification Number
NSN	National Stock Number
NTK	Network
NWW	Non-Wire Wound
PL	Plate
QTY	Quantity
RCPT	Receptacle
RCU	Receiver Control Unit
RES	Resistor
RF	Radio Frequency
ROM	Read Only Memory
RPSTL	Repair Parts and Special Tools List
RTNR	Retainer
SB	Supply Bulletin
SHLD	Shield
SLFLKG	Self-Locking
SMR	Supply, Maintenance, and Recoverability
SP	Special Purpose
SPEC	Special
TM	Technical Manual

**GLOSSARY - Continued.**

TMDE	Test, Measurement, and Diagnostic Equipment
TOTL	Totalizing
U/M	Unit of Measure
LOC	Usable on Code
WRG	Wiring

**GLOSSARY 2**



## Linear Measure

1 centimeter = 10 millimeters = 0.39 inch  
1 decimeter = 10 centimeters = 3.94 inches

## Weights

1 centigram = 10 milligrams = 0.15 grain  
1 decigram = 10 centigrams = 1.54 grains  
1 gram = 10 decigrams = 0.035 ounce  
1 dekagram = 10 grams = 0.35 ounce  
1 hectogram = 10 dekagrams = 3.52 ounces  
1 kilogram = 10 hectograms = 2.2 pounds

## Approximate Conversion Factors

<u>To Change</u>	<u>To</u>	<u>Multiply By</u>
inches	centimeters	2.540
feet	meters	0.305
ounces	grams	28.349
pounds	kilograms	0.454

## Temperature (Exact)

$$^{\circ}\text{F} = \frac{9}{5}^{\circ}\text{C} + 32$$
$$^{\circ}\text{C} = \frac{5}{9} (^{\circ}\text{F} - 32)$$

